



RDS Metro

Installation and Parts Manual



MONROE SNOW & ICE CONTROL

A Division of Monroe Truck Equipment

1051 W. 7th Street

Monroe, WI 53566

Phone: 608-328-8127

Fax: 608-329-8488

TABLE OF CONTENTS

SAFETY INSTRUCTIONS	Page 2
MAINTENANCE INSTRUCTIONS	Page 3-4
LUBRICATION CHART	Page 4
INSTALLATION INSTRUCTIONS	Page 5-9
WIRING SCHEMATIC	Page 10
OPERATING INSTRUCTIONS	Page 13
GENERAL INFORMATION	Page 14
TORQUE CHART	Page 14
REPLACEMENT PARTS	Page 16-39
HOW TO ORDER PARTS	Page 40
RETURN POLICY	Page 40
WARRANTY INFORMATION	Page 41

SAFETY INSTRUCTIONS

- Read all installation, safety and maintenance instructions completely before operating this equipment
- Keep all personnel clear of moving parts while equipment is being operated.
- Do not operate equipment in need of maintenance! Repair immediately!
- While operating this equipment, use common sense, use caution, be alert and be safety-conscious.
- Always keep latch handle in lock position with welded chain when not dumping material.
- **Always carefully block up the body, using the body prop, before working under equipment.**
- **Do not disconnect any hydraulic lines with body raised, unless properly blocked up.**
- **Do not race the engine while unloading/dumping.**
- **Do not load the hoist beyond its capacity.**



DANGER

AVOID HIGH-PRESSURE FLUIDS

Escaping fluid under pressure can penetrate the skin causing serious injury.

Avoid the hazard by relieving pressure before disconnecting hydraulic or other lines. Tighten all connections before applying pressure.

Search for leaks with a piece of cardboard. Protect hands and body from high pressure fluids.

If an accident occurs, see a doctor immediately. Any fluid injected into the skin must be surgically removed within a few hours or gangrene may result.

MAINTENANCE INSTRUCTIONS

CAUTION: Always replace shields and covers when maintenance is complete.

- Allow hydraulic system to warm up before using.
- Maintain a $\frac{3}{4}$ full reservoir using high grade non-foaming oil.
- Avoid getting contaminants in reservoir when filling.
- Replace filter cartridge with new cartridge at least twice a year and more often if necessary.
- Clean quick disconnects before taking apart or connecting.
- Protect quick disconnects while in use and after taking apart with oily rag or other suitable protection.
- Access to the top of the hoist cylinder can be gained by removing the doghouse cover.
- Lubricate all fittings at regular intervals. Refer to lubrication chart on page 4. The grease fittings are located as follows:

Conveyor Bearings 3 fittings (Page 4)
Body Prop 1 fitting per prop (Page 22)
Latch Lever (Front) 2 fittings (Page 20)
Cylinder Top Pivot 2 fittings (Not Shown)
Gate Jack 2 fittings (Page 21)
Rear Body Hinge 2 fittings (Page 23)
Tailgate Latch Pivot (Rear) . . . 6 fittings (Not Shown)
Cylinder Bottom Pivot 2 fittings (Page 6)
Tailgate Hinges 2 fittings (Page 20)

- Greasing pump shaft u-joints and slip end of slip u-joints is recommended with each truck lubricating.
- A coating of grease on spreader drag chain tightener bolt is recommended for easier chain adjustment.
- Conveyor chains should be checked shortly after initial start up and frequently thereafter. Chains should be cleaned, oiled and tightened if slack is excessive. Tighten if the chain contacts the lower flange on the longmember less than 30" from the end of the body.

MAINTENANCE INSTRUCTIONS

Continued from previous page...

- Hosing down and cleaning spreader after each use, and repainting or oiling after each season, will greatly prolong spreader life.
- Spreader hopper should be kept empty to prevent materials from freezing around conveyor in severe cold weather.
- Gearboxes should be checked for proper lubrication level, and SAE 90 gear type lubricant added if necessary.
- Gearbox vents, when supplied, should be kept open at all times, or damage may result to seals.

LUBRICATION

All bearing units are factory prelubricated and, therefore, do not require supplemental grease before service life begins. Relubrication, when administered correctly, can increase the life of a bearing substantially. We recommend the following general guidelines to maximize your bearing life:

RPM	Temperature	Environmental Condition	Interval
100 500 1,000	32°F-120°F 32°F-150°F 32°F-210°F	Clean Clean Clean	6-12 months 2-6 months 2 wks to 2 months
1,500 Any	Over 210°F 32°F-150°F	Clean Dirty	Daily to weekly Weekly to monthly
Any Any	Over 150°F Any Temp.	Dirty Very Dirty	Daily to 2 wks Daily to weekly
Any	Any Temp.	Extremely Dirty	Daily to weekly

BEARING, 1.5" 4-BOLT FLANGE
PN: 05030007

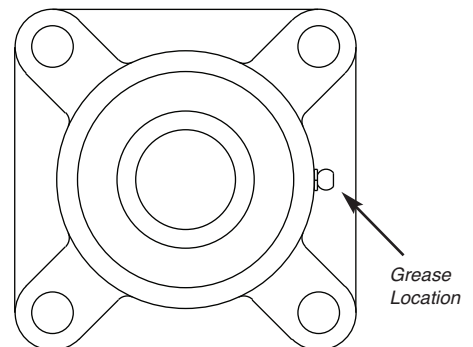

NOTE:

Over lubrication is a major cause of bearing failures. Please relubricate conservatively when unsure of bearing requirements.

When selecting a bearing lubricant, your dealer suggest any lithium-based NLGI #2 grease. For operating temperatures higher than 210°F, please consult your dealer.

INSTALLATION INSTRUCTIONS

Body Mount Instructions

- ** It is recommended that the body be painted before it is mounted on the truck.
- $\frac{3}{8}$ x 2½ bars should be attached to top of truck frame. Weld across rear, fasten in center by welding to existing brackets, if possible, or fabricate a bracket that can be welded to the bar and bolted to the frame. Front of bar will extend under the hoist frame assembly.
 - Place the body on the truck, leaving a minimum 4" of cab clearance or a minimum of 1" stack clearance. Note - Only lift body with a suitable lifting device, such as chain falls. **Do not go/work under a raised body.**
 - Make sure the body is centered on and parallel to the truck frame. Body should overhang truck frame by about 6".
 - Top of pintle plate hinges should be flush with top of added bar. For strength, notch pintle plate to allow it to fit between the frame rails. (See below)
 - Insert the pintle plate between the frame rails until it is about ½" past flush. This will help to obtain good welds on both sides of the pintle plate. Keep assembly square and even to the truck frame. Note - Surfaces being welded must be cleaned of paint, grease or dirt.

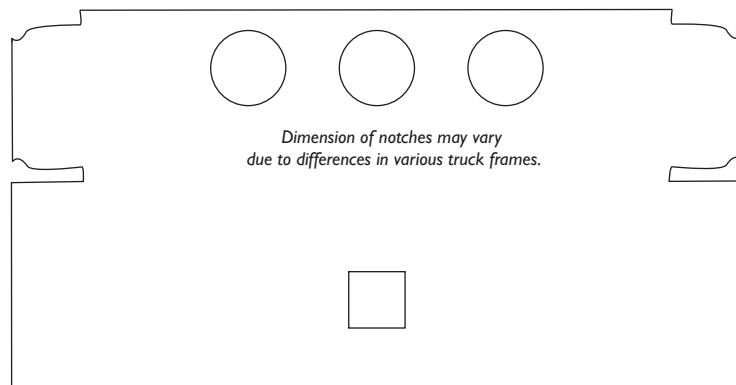

Pintle plate after notching

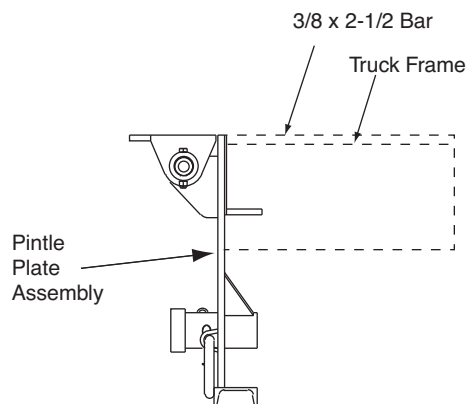

INSTALLATION INSTRUCTIONS

RDS Metro Hoist Frame Installation (Cradle Assembly)

- Make sure the hoist frame is correctly located, centered and square with the truck frame. Clamp the frame mounting angles to the bottom of the hoist frame and to the outside of the truck frame rails.
- Mark the mounting angles for drilling. Drill (2) $2\frac{1}{32}$ " holes per side through mounting angles and frame

and install $\frac{5}{8}$ " x 2 capscrews, flat washers and lock nuts.

Note - Always use Grade 8 bolts, nuts and hardened washers when fastening to a truck frame.

- Apply a rust inhibitor or paint to drilled holes

Caution: Be careful of brake lines, wiring, etc. inside the truck frame when drilling through the truck frame.

- Weld the (2) mounting angles on 3 sides to the hoist frame.
- Remove the (2) upper/lower portion retaining bolts before cylinder operation. These bolts are to hold the hoist frame assembly together during shipment and are not used during normal operation.

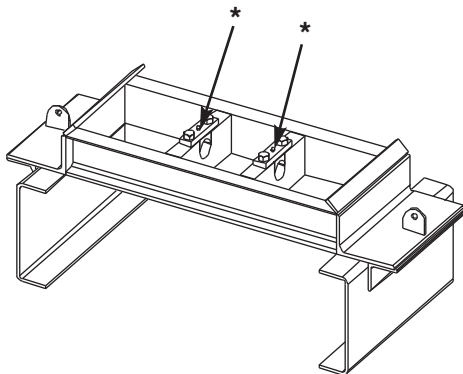

* Grease locations (2)

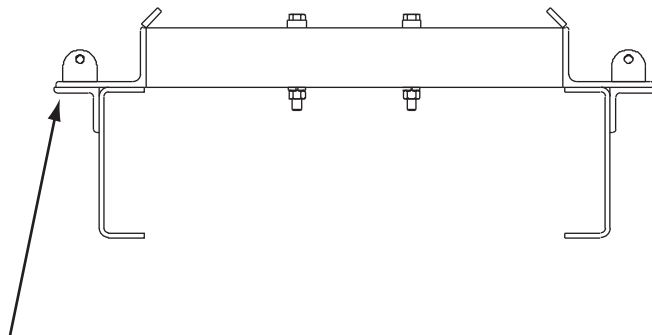

Mounting angles (2) shipped loose. Weld to hoist frame (3 sides).
Bolt to truck frame--Do not weld to truck frame.
**Assembly will be placed over the 3/8 x 2-1/2 bars added to the top of the truck frame.

INSTALLATION INSTRUCTIONS

Body Prop Installation

The Monroe Body Prop is designed and intended for use to support an **empty** truck body in the raised position to permit service work to be performed safely beneath a raised body. Two props should be used, one on each side. Body Props come in pairs, right hand and left hand.

- Raise body to desired height and brace it securely with a large block of solid, hard wood before beginning installation.
- Attach prop arm to prop pivot mount with $\frac{5}{16}$ " x 3" roll pin. Position prop pivot mount against outside of truck frame, approximately 50" to 60" ahead of rear dump body hinge. (This dimension is measured from center of hinge pin to center of prop pivot mount tube.) This measurement may vary depending on chassis make and/or desired body propped height. Allow saddle end of prop arm to rest on top of front spring shackle as shown. Using prop pivot mount as a guide, mark location of holes on truck frame and drill (2) $1\frac{7}{32}$ " holes per side. Fasten prop pivot mount to truck frame with $\frac{1}{2}$ " x $1\frac{3}{4}$ " bolts and lock nuts.
- Raise prop arm to free standing position by allowing prop arm to rest against rear flange of prop pivot mount. Place longsill bracket in prop arm saddle. Position longsill bracket against the upper outside of body longsill in order to allow room for clearance when body is in the lowered position. Weld longsill bracket securely in place.

- To operate Body Prop, raise the body to desired height, shut off all power, and raise both prop arms to a free standing position. Lower body slowly until longsill brackets contact prop arm saddles. DO NOT POWER HOIST DOWN!!

- To place Body Prop in storage position, simply reverse

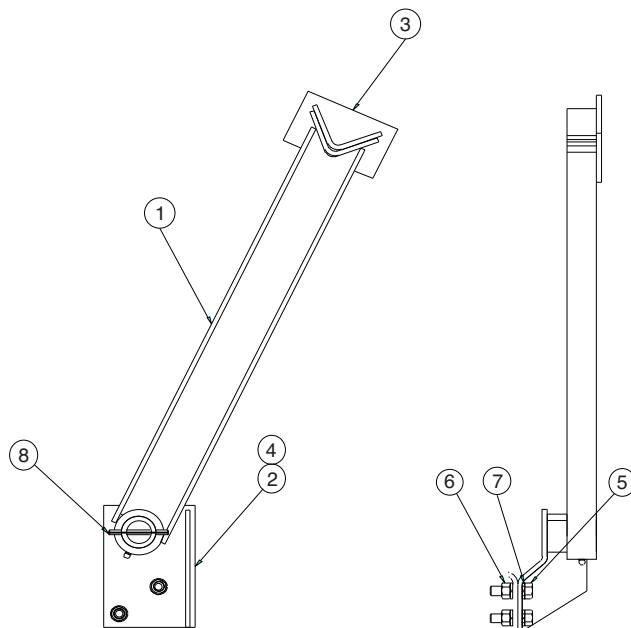

INSTALLATION INSTRUCTIONS

Floor Cover Install

1. Remove tailgate insert assembly by removing (4) bent pins welded to the tailgate.
3. From rear of body, slide poly floor cover (holes to rear) under front panel.
4. Fasten poly floor cover to rear floor plate with (3) $\frac{3}{8}$ x 1 $\frac{1}{4}$ bolts, nuts and washers.
Note - Poly floor cover fits under floor plate.
5. Fasten rear floor plate to body with (4) $\frac{3}{8}$ x 1 bolts, nuts & washers.
6. Replace tailgate insert with tailgate disrupter plate using (4) pins removed.

INSTALLATION INSTRUCTIONS

Adding Hydraulic Oil

- Use a quality hydraulic fluid of 150 SSU @ 100° F, which contains corrosion and oxidation inhibitors and a foam depressant. This is approximately the equivalent of SAE 10W or lighter weight oil, or use Type A automatic transmission oil for improved performance in cold weather. Initially, fill the reservoir according to diagram below. After 2 or 3 cycles, refill the reservoir to the sight glass level with the body down. **DO NOT OVERFILL THE RESERVOIR!** Maintain a level no closer than 2" from top of reservoir.
- With normal use and working conditions the hydraulic filter should be cleaned or changed every time the hydraulic oil is changed. With heavy use or very dusty working conditions, the hydraulic filter should be changed or cleaned more often.

KEEP OIL CLEAN! USE CLEAN CONTAINERS, FUNNELS AND OTHER EQUIPMENT!

Reservoir Size	Initial Fill
20 gallon	13 gallons
30 gallon	24 gallons

WIRING SCHEMATIC

Install the lights and connect the wiring using the diagram below.

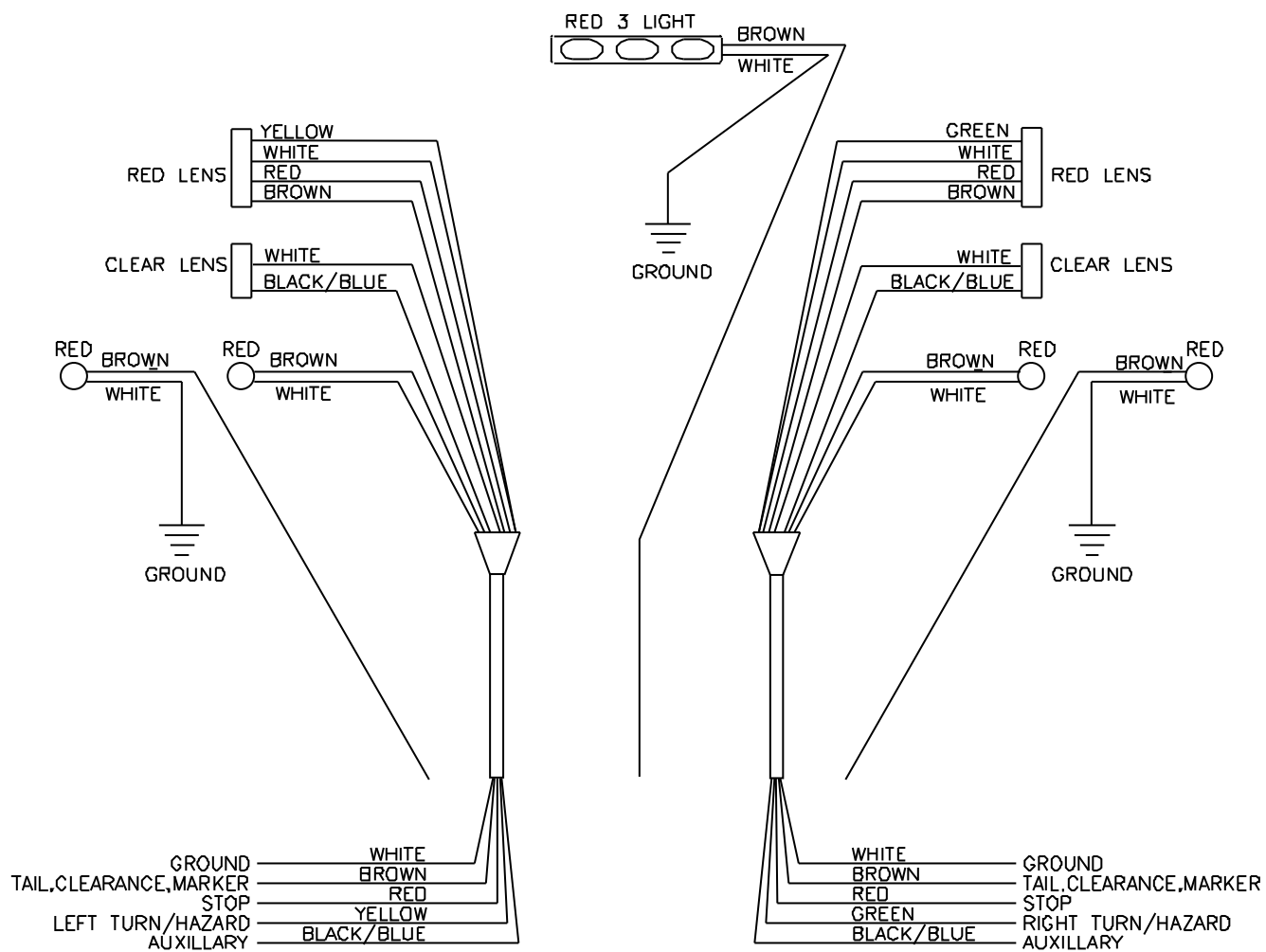

HYDRAULIC SCHEMATICS

MONROE RDS METRO BODY

HYDRAULIC TROUBLE SHOOTING CHART

<p>CONDITION 1 Pump cavitation recognized by excessive noise.</p> <p>CAUSE</p> <ul style="list-style-type: none"> • Air entering system through suction lines. • Suction line kinked, twisted or too long. • Inadequate size suction line. • Oil too heavy. • Excessive pump speed. Normal pump speed 1200 to 1500 RPM. <p>CORRECTION</p> <ul style="list-style-type: none"> • Check line from reservoir for possible leaks. • Install suction line as short and straight as possible. • Increase suction line size. • Drain and replace with a low viscosity non-detergent oil. • Pump capacity is 16 GPM at 1000 RPM. Decrease PTO speed accordingly. 	<p>CONDITION 2 Erratic operation of conveyor and/or spinner.</p> <p>CAUSE</p> <ul style="list-style-type: none"> • Low oil. • Worn or defective motor. • Dirty, worn or defective flow control valve. • Plugged filter. • Relief valve setting too low. • Pump cavitation. • Air vent on reservoir tank is blocked. <p>CORRECTION</p> <ul style="list-style-type: none"> • Fill reservoir to a $\frac{3}{4}$ full level. • Repair or replace motor.* • Clean, repair or replace flow control.* • Replace filter element and clean filter. • Adjust relief valve for 1500 PSI. • Refer to pump section. • Clean or replace vent cap to admit atmospheric pressure to inside of the tank.
<p>CONDITION 3 Slow operation of conveyor and/or spinner.</p> <p>CAUSE</p> <ul style="list-style-type: none"> • Worn or defective pump. • Worn or defective motor. • Pump cavitation. • Insufficient pump speed. <p>CORRECTION</p> <ul style="list-style-type: none"> • Repair or replace pump.* • Repair or replace motor.* • Refer to pump section. • Pump capacity is 16 GPM at 1000 RPM. Increase PTO accordingly. 	<p>CONDITION 4 Conveyor and/or spinner will not operate.</p> <p>CAUSE</p> <ul style="list-style-type: none"> • Quick disconnects are dirty, damaged, or improperly connected. • Hose connections wrong. • Foreign material in valve compensator. <p>CORRECTION</p> <ul style="list-style-type: none"> • Clean or replace and properly connect. • Refer to illustration. • Remove compensator and clean.

OPERATING INSTRUCTIONS

CAUTION:

- When starting up new equipment, be sure everyone is standing clear, watch for anything that may require shutting system down.
- Be sure lever on valve is moved completely to OFF position before working in or around spreading equipment.
- Be sure the engine is off and the key is removed and the parking brake is set. Prop the body up if working underneath.

INITIAL START UP:

1. Fill reservoir about $\frac{3}{4}$ full with high-grade non-foaming hydraulic oil. KEEP OIL CLEAN!
2. Move valve on-off lever to OFF position.
3. Open conveyor and spinner knobs on valve.
4. Engage PTO and allow hydraulic oil to circulate several minutes to warm up.
5. Move valve on-off lever to ON position.
6. Check entire hydraulic system for leaks. Use a piece of cardboard, not your hands.
7. Examine conveyor and spinner to see if they are running in right direction. Direction can be reversed by switching hoses at motor ports.
8. Fill reservoir to $\frac{3}{4}$ full.
9. Hydraulic system is ready for use.



SPREADER OPERATION:

1. Start truck engine and allow hydraulic system to warm up by shutting off spinner and conveyor knobs and moving on-off lever to ON position.
2. Turning the knob marked "spinner" counter-clockwise will increase the spinner speed and width of spread.
3. Turning the knob marked "conveyor" counter-clockwise will increase the conveyor speed and thus the amount of material spread.
4. The gate on the rear of the box will also allow more material to pass to the spinner when opened wider.
5. A little experimenting with the different positions of the baffles and the spinner speed control will show the patterns spread exactly as desired for direction and width.
6. The control valve may be turned on and off or adjusted while truck is in motion.
7. Spinner and conveyor may be stopped at the same time without changing their valve settings by moving the on-off lever to OFF position.

GENERAL INFORMATION

- Location descriptions are noted in direction of travel. (i.e. front, rear, left and right.)
- Delivery of replacement parts is subject to our sales delivery terms.
- Use only **Monroe Truck Equipment** O.E.M. replacement parts. Failure to do so will void warranty.
- Replacement parts listed in this manual reflect our most common items. If you do not find the part you require, please call your distributor.
- **Monroe Truck Equipment** reserves the right to make revisions or alterations to this parts manual.

TORQUE CHART

SIZE	 GRADE 2	 GRADE 5	 GRADE 8
1/4-20	50 IN-LBS	75 IN-LBS	9 FT-LBS
3/8-16	15 FT-LBS	23 FT-LBS	35 FT-LBS
1/2-13	35 FT-LBS	55 FT-LBS	80 FT-LBS
5/8-11	75 FT-LBS	110 FT-LBS	170 FT-LBS
3/4-10	130 FT-LBS	200 FT-LBS	280 FT-LBS
1-8	190 FT-LBS	480 FT-LBS	680 FT-LBS
1 1/4-7	380 FT-LBS	840 FT-LBS	1360 FT-LBS

NOTES

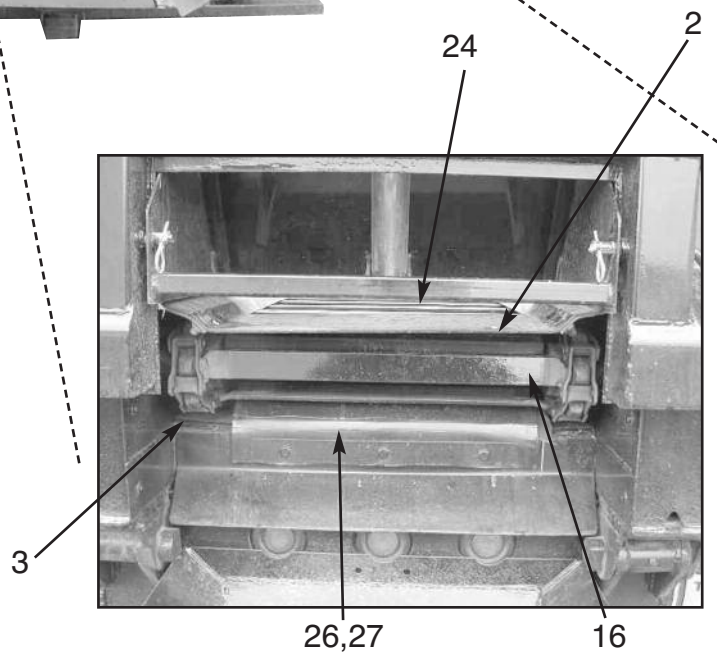
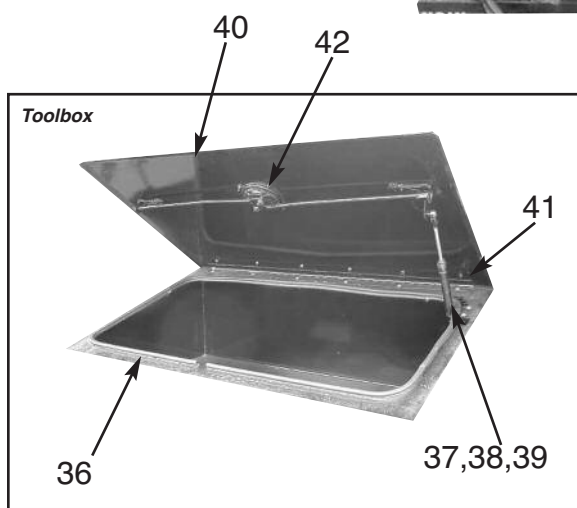
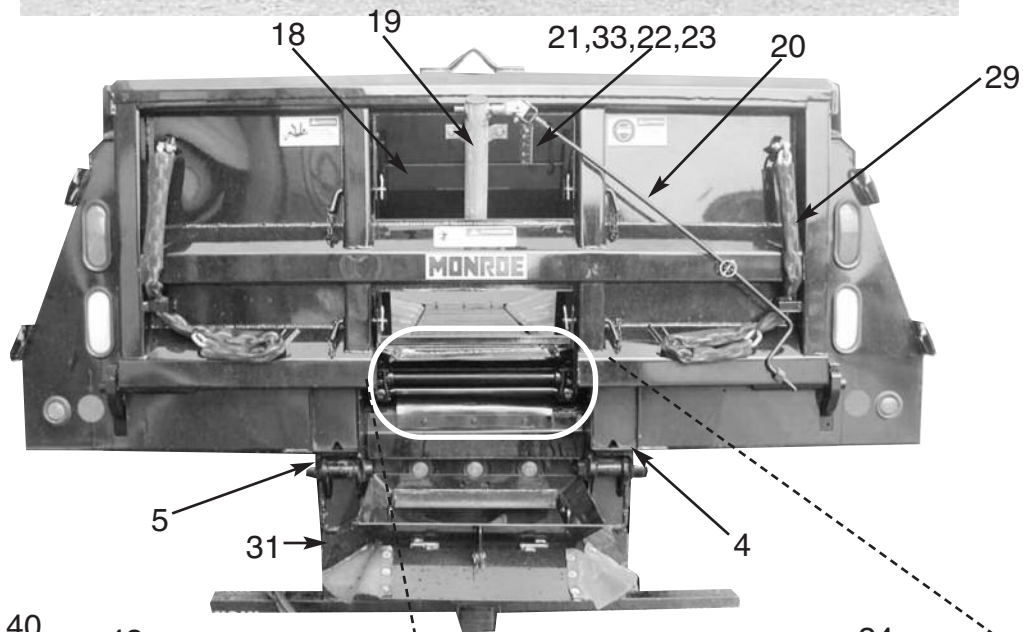
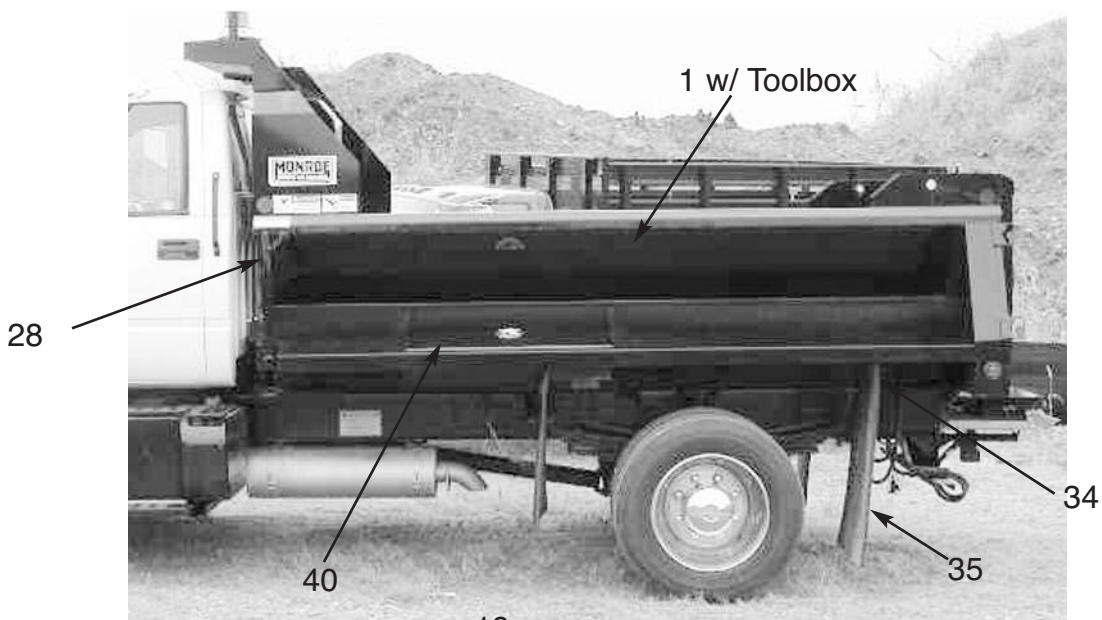

RDS METRO 108-96-33 PARTS LIST

ITEM	QTY	PART #	DESCRIPTION
1	1	00059856*	Hopper Weldment, Metro, 108-95-33
	1	00059874*	Hopper Weldment, Metro, 108-96-33 w/Toolbox
2	1	00059863*	Floor Weldment, 9'
3	1	00059864	Sub Floor, Metro, 9' Poly
4	1	00051808*	End Cap, RH
5	1	00051809*	End Cap, LH
6	1	00049645*	Cover Plate, Doghouse (Not Shown)
7	2	00053172*	Slider Plate Weldment, Bearing Adjuster (Not Shown)
8	2	05050212	Bushing, UHMW, .8125" ID x 1.343 (Not Shown)
9	2	05035071	Spring, Compression, 2.187 OD (Not Shown)
10	3	05030007	Bearing, 1½" ID, 4-Bolt Flange (Not Shown)
11	1	00048746	Shaft, Idler, 1½" x 41½ OAL (Not Shown)
12	3	05050052	Key, Machinery, ⅜ x 2½ (Not Shown)
13	4	05033025	Sprocket, 6 Tooth, 1½" Bore (Not Shown)
14	1	05007427	Gear Box, 25:1, 1½" x 36 ¾ Shaft (See pages 36-37) (Not Shown)
15	1	05006060	Motor, Hydraulic, White, 6.3 CI, 4-Bolt (See pages 38-39) (Not Shown)
16	1	05036386	Chain Pintle, 82 Links, 41 Flats
17	1	00053203*	Cover, Shaft, Front (Not Shown)
18	1	00051855*	Door Weldment, Metro, Rear, 10 Gauge (Not Shown)
19	1	00042534	Jack Assembly, Door, Rear, Cut 4"
20	1	00052283	Crank Jack Assembly
21	1	00048740*	Insert Weldment
22	2	00051871	Wiper, Insert
23	2	00038480*	Support, Rubber Flap
24	1	00051850*	Floor Plate, Rear
25	1	00051851*	Disrupter (Not Shown)
26	2	05050056	Wiper, ⅝ x 5 x 17
27	2	00053253*	Support, Rubber Flap
28	1	05050314	Handle Grip, 1 x 4⅝
29	2	00058808	Chain, ⅜ x 42⅜
30	1	00051846	Cradle Assembly (Not Shown)
31	1	00051873	Pintle Plate Assembly
32	1	05050645	Hoist, Mailhot, 90 x 4-3, SA (Not Shown)
33	1	05050426	Indicator, Aluminum, 9" Gate
34	2	00051921	Bracket, Mud Flap
35	2	05050678	Mud Flap, 24 x 30
Toolbox Assembly			
36	8½ FT	05050702	Trim, ⅜" Bulb, Black
37	1	05050706	Shock Absorber, Gas, 3½" Stroke
38	1	05050671	Shock Absorber Mounting Bracket, 90°
39	2	05050622	Clip, Safety for 10MM Ball Stud
40	1	00056831*	Lid Weldment, ToolBox, Metro
41	1	00058807	Hinge, Tool Box
42	1	05051056	Lock, Flush Stainless Steel

* Part indicated can be ordered as

- A Mild Steel
- B 304 Stainless Steel
- C 409 Stainless Steel

Please indicate material preference at time of order.

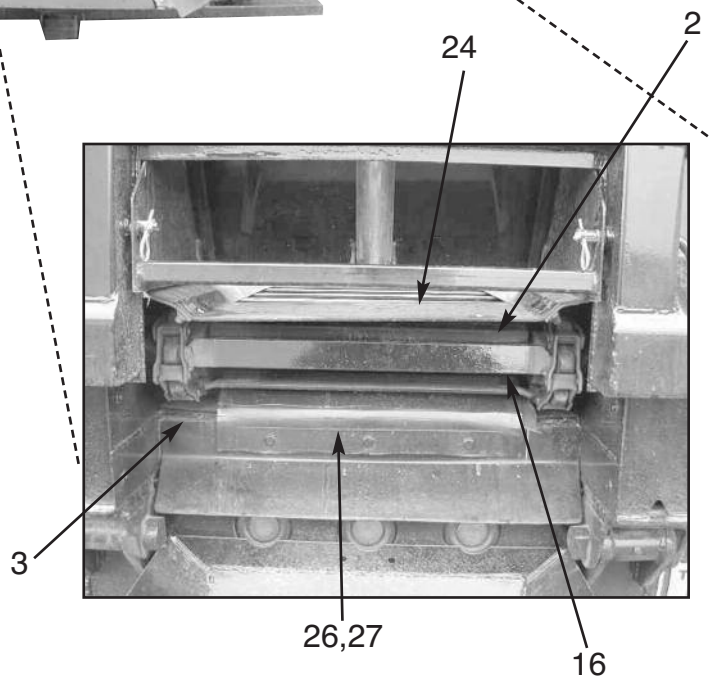
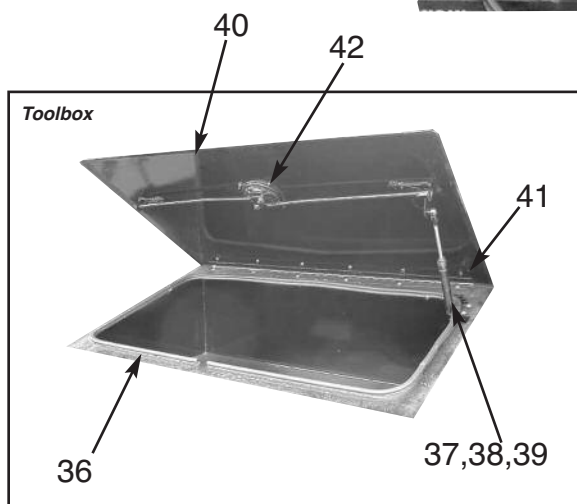
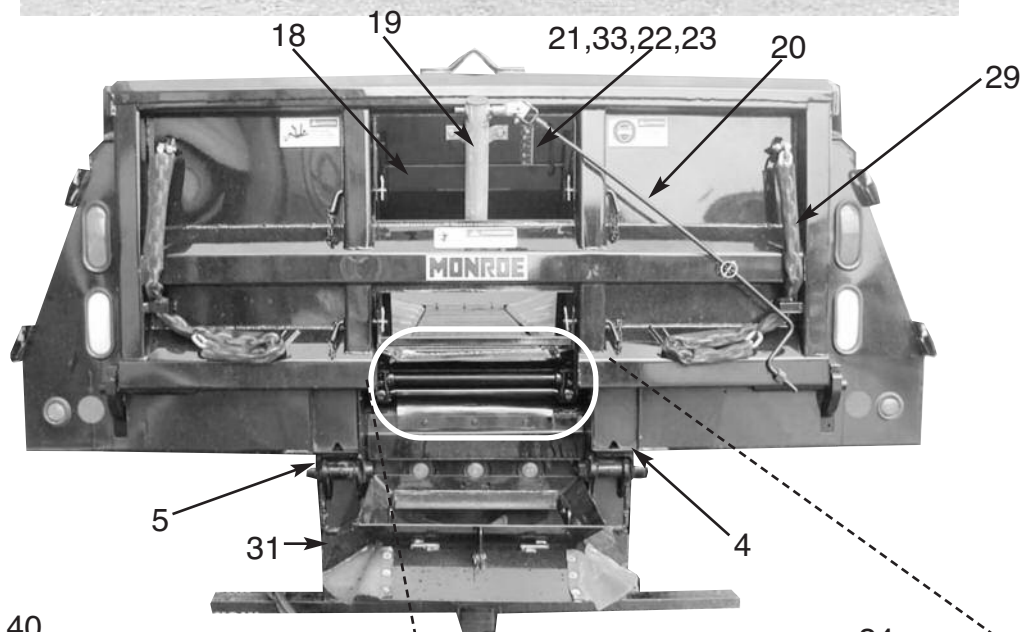
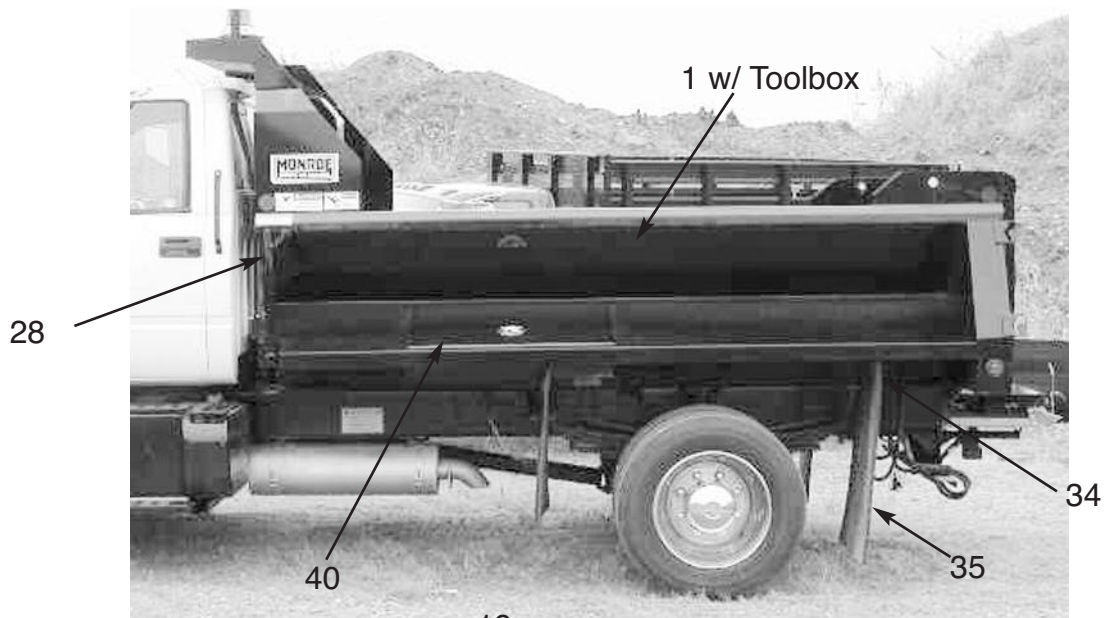

RDS METRO 132-96-33 PARTS LIST

ITEM	QTY	PART #	DESCRIPTION
1	1	00059832*	Hopper Weldment, Metro, 132-96-33, 10 Gauge
	1	00058810*	Hopper Weldment, Metro, 132-96-33, 12 Gauge
	1	00049675*	Hopper Weldment, Metro, 132-96-33 w/Toolbox, 12 Gauge
2	1	00051848*	Floor Weldment, 11'
3	1	00051867	Sub Floor, 11' Poly
4	1	00051808*	End Cap, RH
5	1	00051809*	End Cap, LH
6	1	00049645*	Cover Plate, Doghouse (Not Shown)
7	2	00053172*	Slider Plate Weldment, Bearing Adjuster (Not Shown)
8	2	05050212	Bushing, UHMW, .8125" ID x 1.343 (Not Shown)
9	2	05035071	Spring, Compression, 2.187 OD (Not Shown)
10	3	05030007	Bearing, 1½" ID, 4-Bolt Flange (Not Shown)
11	1	00048746	Shaft, Idler, 1½" x 41½ OAL (Not Shown)
12	3	05050052	Key, Machinery, ⅜ x 2½ (Not Shown)
13	4	05033025	Sprocket, 6 Tooth, 1½" Bore (Not Shown)
14	1	05007427	Gear Box, 25:1, 1½" x 36 ⅜ Shaft (Not Shown) (See Pages 36-37)
15	1	05006060	Motor, Hydraulic, White, 6.3 CI, 4-Bolt (Not Shown) (See Pages 38-39)
16	1	05036260	Chain Pintle, 102 Links, 51 Flats
17	1	00053203*	Cover, Shaft, Front (Not Shown)
18	1	00051855*	Door Weldment, Metro, Rear
19	1	00042534	Jack Assembly, Door, Rear, Cut 4"
20	1	00052283	Crank Jack Assembly
21	1	00048740*	Insert Weldment
22	2	00051871	Wiper, Insert
23	2	00038480*	Support, Rubber Flap
24	1	00051850*	Floor Plate, Rear (Not Shown)
25	1	00051851*	Disrupter (Not Shown)
26	2	05050056	Wiper, ⅝ x 5 x 17
27	2	00053253*	Support, Rubber Flap
28	1	05050314	Handle Grip, 1 x 4.625
29	2	00058808	Chain, ⅜ x 42⅜
30	1	00051846	Cradle Assembly (Not Shown)
31	1	00051873	Pintle Plate Assembly
32	1	05050645	Hoist, Mailhot, 90 x 4-3, SA (Not Shown)
33	1	05050426	Indicator, Aluminum, 9" Gate
34	2	00051921	Bracket, Mud Flap
35	2	05050678	Mud Flap, 24 x 30
Toolbox Assembly			
36	8½ FT	05050702	Trim, ⅜" Bulb, Black
37	1	05050706	Shock Absorber, Gas, 3½" Stroke
38	1	05050671	Shock Absorber Mounting Bracket, 90°
39	2	05050622	Clip, Safety for 10MM Ball Stud
40	1	00056831*	Lid Weldment, ToolBox, Metro
41	1	00058807	Hinge, Tool Box
42	1	05051056	Lock, Flush Stainless Steel

* Part indicated can be ordered as

- A Mild Steel
- B 304 Stainless Steel
- C 409 Stainless Steel

Please indicate material preference at time of order.

RDS METRO HOPPER WELDMENT W/ TOOL BOX

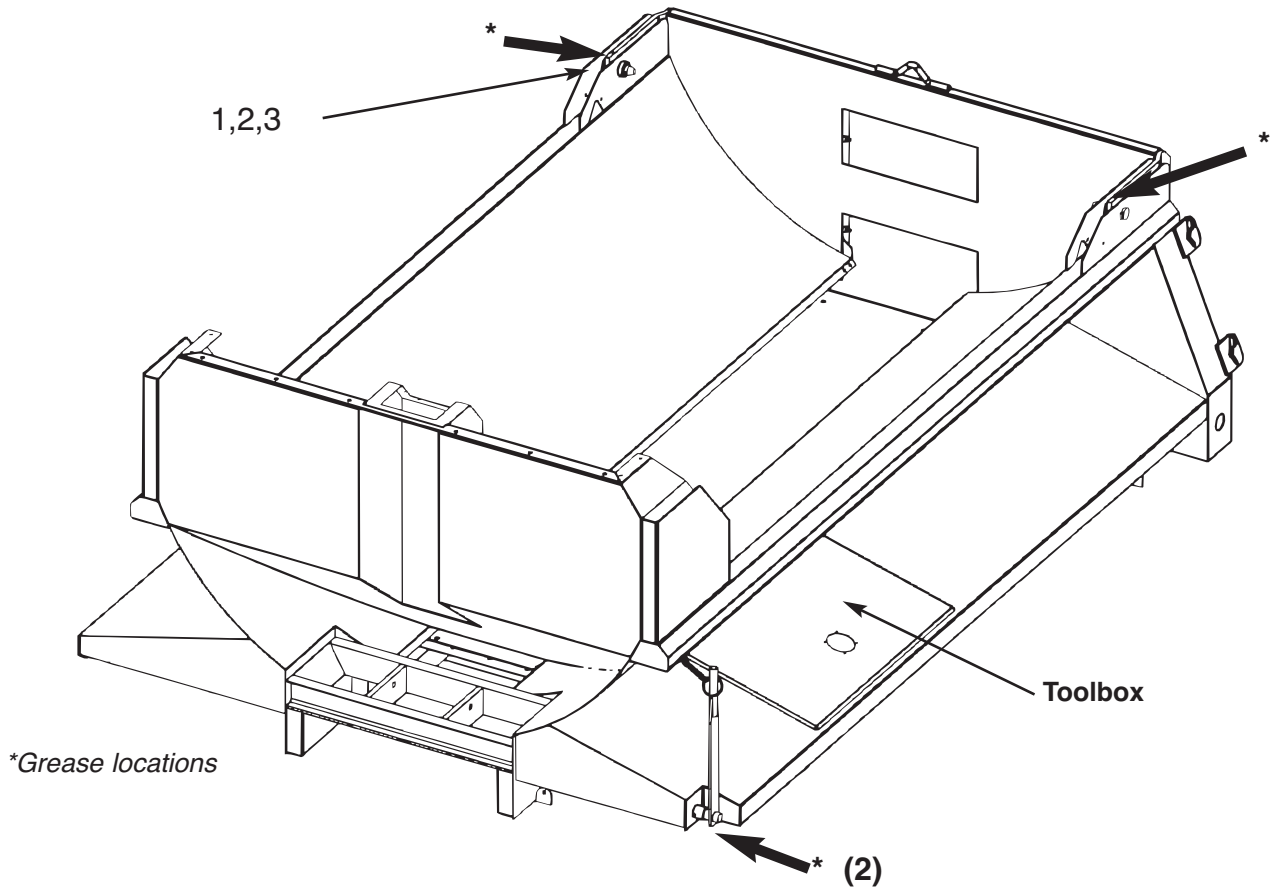

ITEM	QTY	PART #	DESCRIPTION
1	2	00034776	Mounting Pin, Tailgate
2	2	05022106	Lynch Pins, $\frac{3}{16}$
3	2	00051885	Bushing, Tailgate Hinge, $\frac{5}{8}$

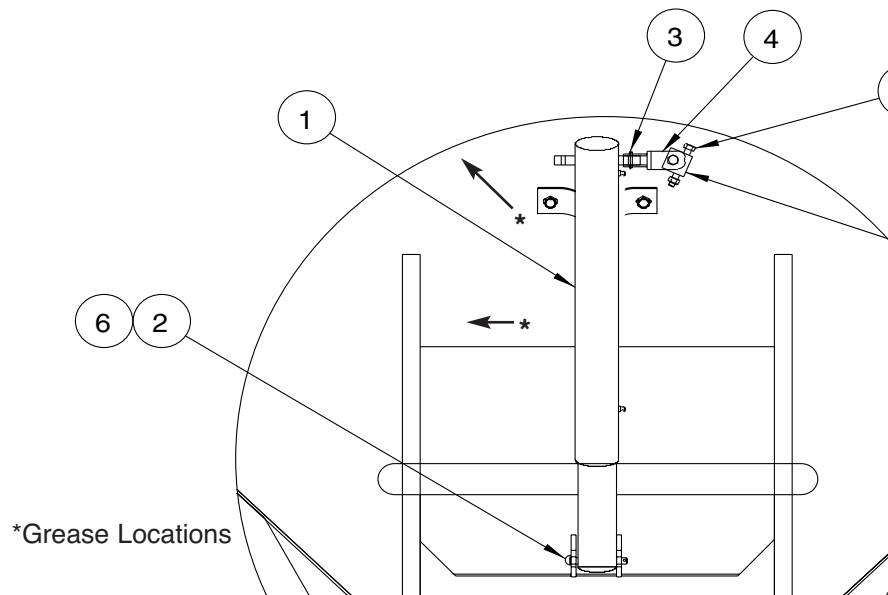

00042534 JACK ASSEMBLY, DOOR

ITEM	QTY	PART #	DESCRIPTION
1	1	05022134	Pin, $\frac{3}{8}$ " DIA x 3" OAL, Clevis, Zinc
2	1	05022072	Pin, $\frac{5}{32}$ x $\frac{7}{8}$, Roll, Zinc
3	1	05050257	Jack, Door New Style, Universal
4	1	05050258	Clevis, Door Jack
5	1	05051455	Universal Joint, UHMW, $1\frac{1}{4}$ Square
6	1	05022021	Pin, $\frac{1}{8}$ x 1, Cotter
7	2	05010623	Bolt, $\frac{5}{16}$ -18 x $2\frac{1}{4}$, G8, HHCS, Zinc
8	2	05020909	Nut, $\frac{5}{16}$ -18, GC, Toplock, C&W

00052283 CRANK ASSEMBLY, JACK, 39"

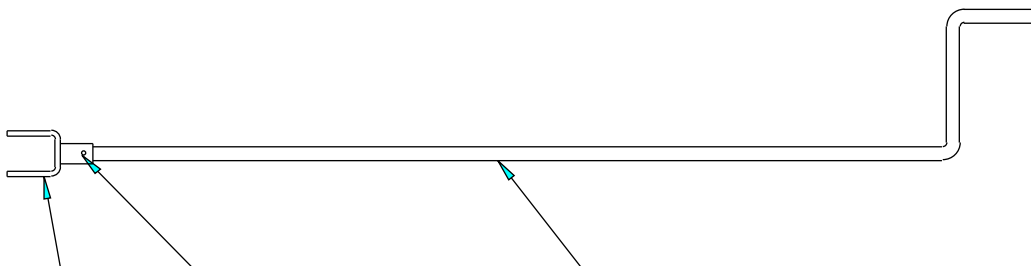

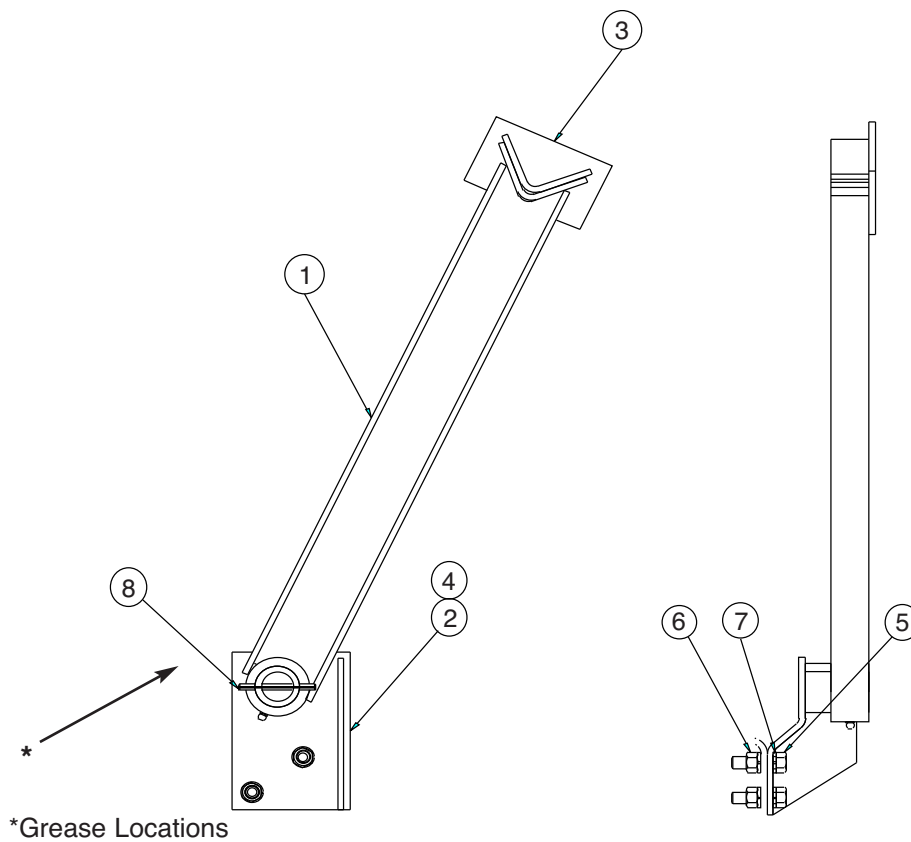

00012214 BODY PROP KIT, RDS, 26 OAL
KIT INCLUDES THE RIGHT & LEFT PROP

ITEM	QTY	PART #	DESCRIPTION
1	2	00032336	Arm Assembly
2	1	00032931	Bracket Weldment, LH
3	2	00032928	Bracket Weldment
4	1	00032932	Bracket Weldment, RH (Not Shown)
5	4	05010739	Bolt, .625-11 x 2, HHCS, Zinc
6	4	05020270	Nut, .625-11, G8, Hex, Zinc
7	4	05021383	Washer, .625, Lock, Heavy, Zinc
8	2	05022044	Pin, $\frac{5}{16}$ x 3, Roll
9	1	00049493	Decal Kit, RDS

See page 7 for installation instructions.

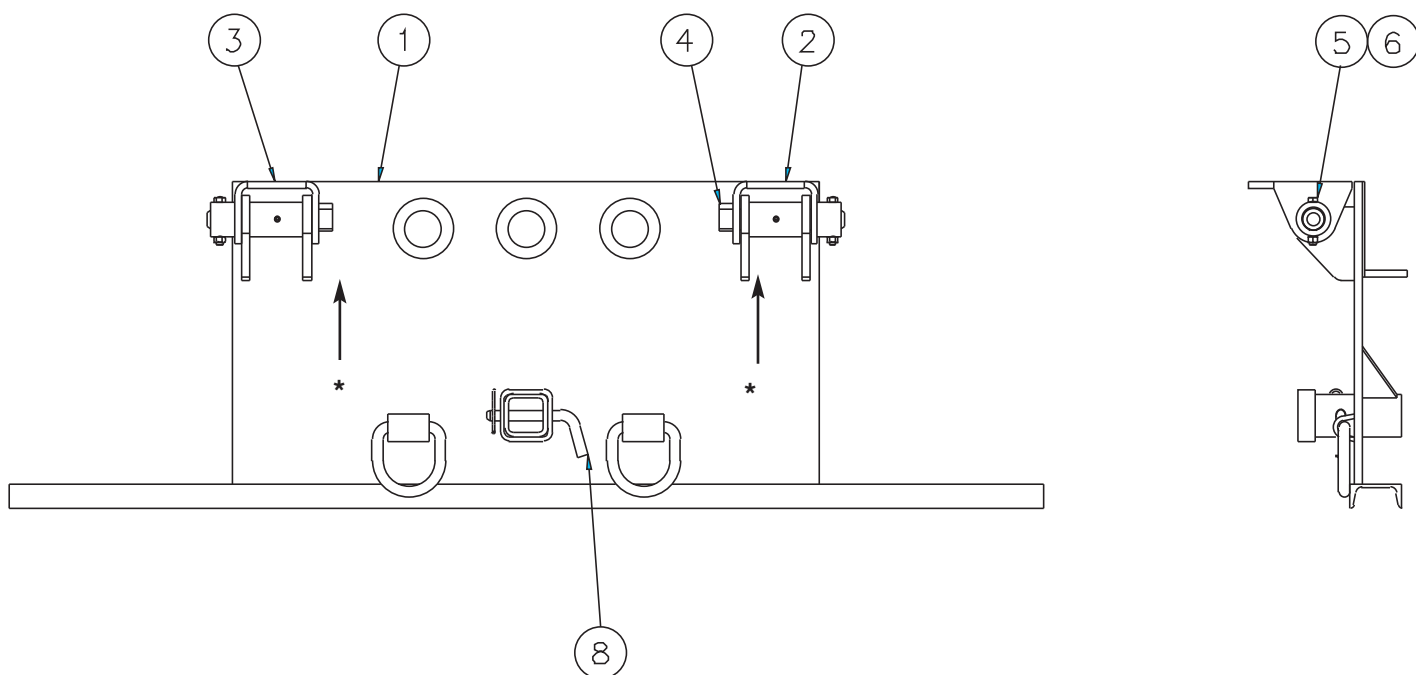

*Grease Locations

00051873 PINTLE PLATE ASSEMBLY, METRO

ITEM	QTY	PART #	DESCRIPTION
1	1	00051819	Pintle Plate Weldment, Metro
2	1	00051874	Hinge Weldment, Hopper, Metro, RH
3	1	00051875	Hinge Weldment, Hopper, Metro, LH
4	2	00051876	Pin, Hinge, Metro, Hopper
5	2	05010649	Bolt, $\frac{3}{8}$ - 16 x 2 $\frac{1}{2}$, G8, HHCS, Zinc
6	2	05020898	Nut, $\frac{3}{8}$ -16, Top Lock, C&W, GR C
7	1	05050701	Cover, Receiver Tube, For 2" x 2" (Not Shown)
8	1	05022155	Pin, $\frac{3}{8}$ x 6, Bent, Zinc, w/ Hair Pin
9	2	05050288	Grease Zerk, $\frac{1}{4}$ - 28, Straight

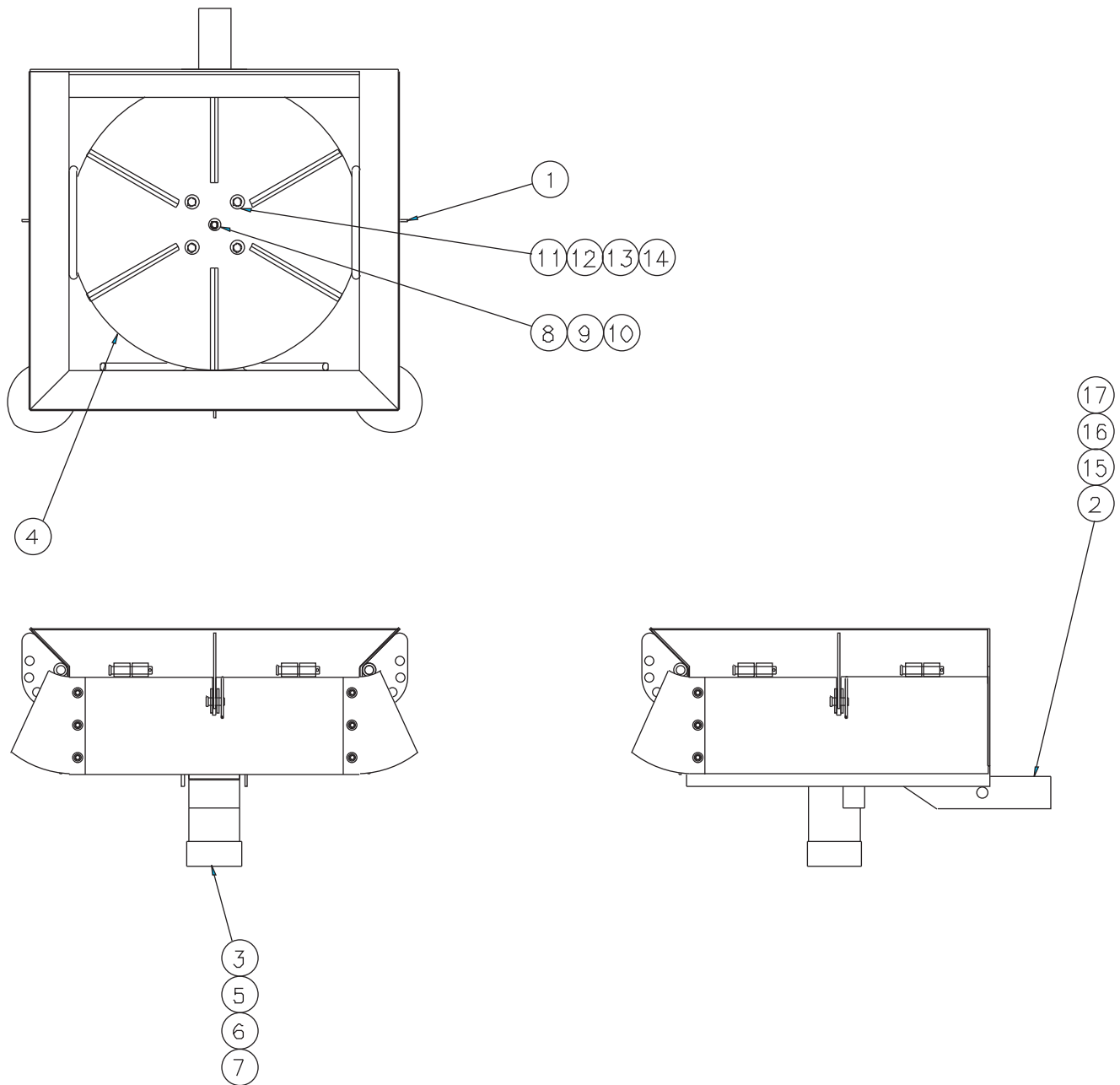

00049673 SPINNER ASSEMBLY, RDS METRO

ITEM	QTY	PART #	DESCRIPTION
1	1	00050702-A	Spinner Sub-Assembly, RDS, Metro, MS
	1	00050702-B	Spinner Sub-Assembly, RDS, Metro, 304 SST
2	1	00049668	Mount Weldment, Spinner
3	1	05006134	Motor, Hydraulic, White, 3.2 CI, 4-Bolt (See Pages 38-39)
4	1	05050070	Spinner Disc, 18" Poly, CCW, Black
5	4	05010642	Bolt, $\frac{3}{8}$ - 16 x $\frac{7}{8}$, G8, HHCS, Zinc
6	1	05051380	Hub, Spinner Assembly, STD, Short
7	4	05021365	Washer, $\frac{3}{8}$, Lock, Zinc
8	1	05010618	Bolt, $\frac{5}{16}$ - 18 x 1, G8, HHCS, Zinc
9	1	05021305	Washer, $\frac{1}{4}$, Flat, Zinc
10	1	05021363	Washer, $\frac{1}{4}$, Lock, Zinc
11	4	05010620	Bolt, $\frac{5}{16}$ - 18 x 1 $\frac{1}{2}$, G8, HHCS, Zinc
12	4	05020265	Nut, $\frac{5}{16}$ - 18, G8, Hex, Zinc
13	4	05021306	Washer, $\frac{5}{16}$, Flat, Zinc
14	4	05021364	Washer, $\frac{5}{16}$, Lock, Zinc
15	2	05010691	Bolt, $\frac{1}{2}$ - 13 x 1 $\frac{1}{2}$, G8, HHCS, Zinc
16	2	05020847	Nut, $\frac{1}{2}$ - 13, GC, Top Lock, C&W
17	2	05021309	Washer, $\frac{1}{2}$, Flat, Zinc

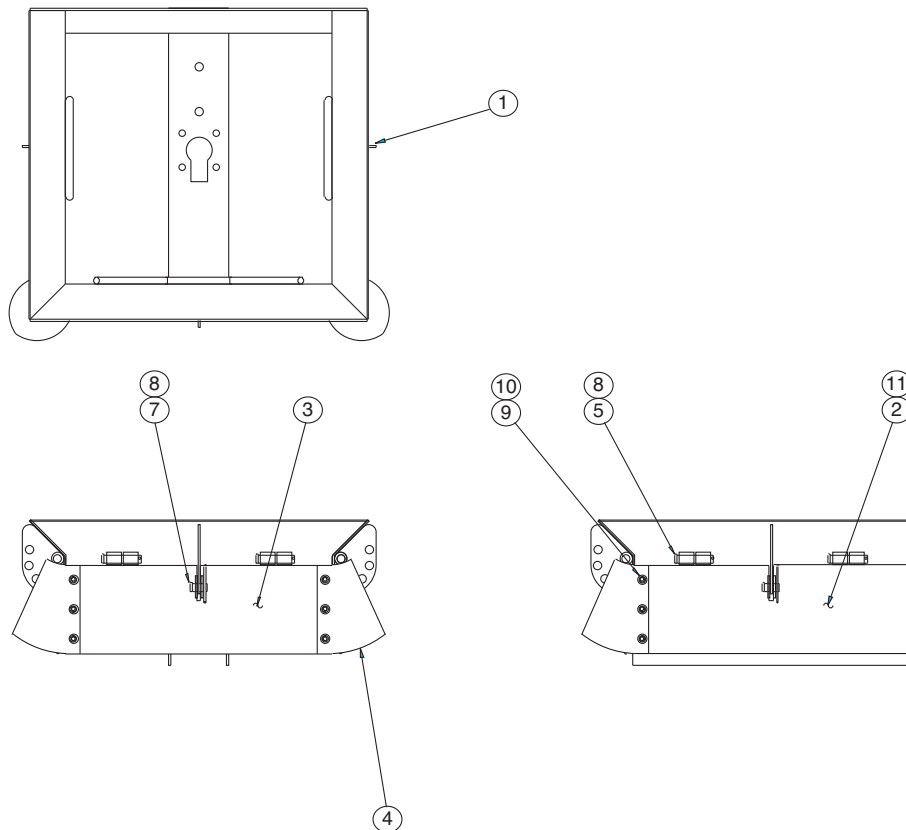

00050702 SPINNER SUB-ASSEMBLY, RDS METRO

ITEM	QTY	PART #	DESCRIPTION
1	1	00049665-A	Spinner Weldment, RDS Metro, MS
	1	00049665-B	Spinner Weldment, RDS Metro, SST
2	1	00049660-A	Deflector Weldment, Side, RH, MS
	1	00049660-B	Deflector Weldment, Side, RH, SST
3	1	00049661-A	Deflector Weldment, Rear, MS
	1	00049661-B	Deflector Weldment, Rear, SST
4	2	05051087	Deflector Skirt, Includes Grommets
5	6	05022055	Pin, Clevis, $\frac{1}{2}$ x 2 $\frac{1}{2}$ OAL
	6	05022069	Pin, Clevis, $\frac{1}{2}$ x 2 $\frac{1}{2}$ OAL, SST
6	6	05022072	Pin, $\frac{5}{32}$ x $\frac{7}{8}$, Roll, Zinc
7	3	05022083	Pin, Clevis, $\frac{1}{2}$ x 1 $\frac{3}{8}$ Long
8	3	05022045	Pin, .0725 x 1.562 x $\frac{3}{8}$, Hair
9	12	05010593	Bolt, $\frac{1}{4}$ - 20 x 1, G8, HHCS, Zinc
	12	05016040	Bolt, $\frac{1}{4}$ - 20 x 1, HHCS, SST
10	12	05020536	Nut, $\frac{1}{4}$ - 20, G2, Nylon Lock, Zinc
	12	05020906	Nut, $\frac{1}{4}$ - 20, Nylon Lock, 316, SST
11	1	00051810-A	Deflector Weldment, Side, LH, MS
	1	00051810-B	Deflector Weldment, Side, LH, SST

LIGHT KIT, RDS, METRO

ITEM	QTY	PART #	DESCRIPTION
1	7	05041251	Light, 2" DIA, Round, Red, Clearance
2	2	05041249	Light, Oval, Red, Stop-Turn-Tail, RDS Body
3	2	05041250	Light, Oval, Clear, Back-Up, RDS
4	7	05041247	Grommet, 2" Round, Light Mount
5	4	05041248	Grommet, Oval, 7.6" x 3.3" Light, MT
6	1	05041245	Harness, Stop-Turn-Tail & Marker, RH
7	1	05041246	Harness, Stop-Turn-Tail & Marker, LH
8	2	05051434	Reflector, Amber, Stick-On

BOLT, NUT & WASHER PARTS LIST

ITEM	QTY	PART #	DESCRIPTION
1	2	05016043	Bolt, $\frac{3}{8}$ - 10 x 14 $\frac{1}{2}$ " w/ 10 $\frac{3}{4}$ " Thread
2	8	05020123	Nut, $\frac{3}{8}$ - 10, G2, Jam, Zinc
3	2	05021312	Washer, $\frac{3}{8}$, Flat, Zinc
4	16	05016942	Screw, #10 - 16 x $\frac{3}{4}$, Hex w/ Head Tek Screw
5	4	05016000	Screw, $\frac{3}{8}$ - 16 x 1 $\frac{1}{4}$, Flat Head
6	10	05010643	Bolt, $\frac{3}{8}$ - 16 x 1, G8, HHCS, Zinc
7	12	05010692	Bolt, $\frac{1}{2}$ - 13 x 1 $\frac{3}{4}$, G8, HHCS, Zinc
8	4	05010689	Bolt, $\frac{1}{2}$ - 13 x 1, G8, HHCS, Zinc
9	4	05010642	Bolt, $\frac{3}{8}$ - 16 x $\frac{7}{8}$, G8, HHCS, Zinc
10	15	05010644	Bolt, $\frac{3}{8}$ - 16 x 1 $\frac{1}{4}$, G8, HHCS, Zinc
11	2	05010690	Bolt, $\frac{1}{2}$ - 13 x 1 $\frac{1}{4}$, G8, HHCS, Zinc
12	8	05010595	Bolt, $\frac{1}{4}$ - 20 x 1 $\frac{1}{2}$, G8, HHCS, Zinc
13	29	05020898	Nut, $\frac{3}{8}$ - 16, Top Lock, C&W, GR C
14	14	05020847	Nut, $\frac{1}{2}$ - 13, GC, Top Lock, C&W
15	8	05020899	Nut, $\frac{1}{4}$ - 20, Top Lock, Zinc
16	16	05021309	Washer, $\frac{1}{2}$, Flat, Zinc
17	4	05021367	Washer, $\frac{1}{2}$, Lock, Zinc
18	4	05021365	Washer, $\frac{3}{8}$, Lock, Zinc
19	1	05022106	Pin, $\frac{3}{16}$, Lynch

TOP GRATE KIT, METRO, 9'

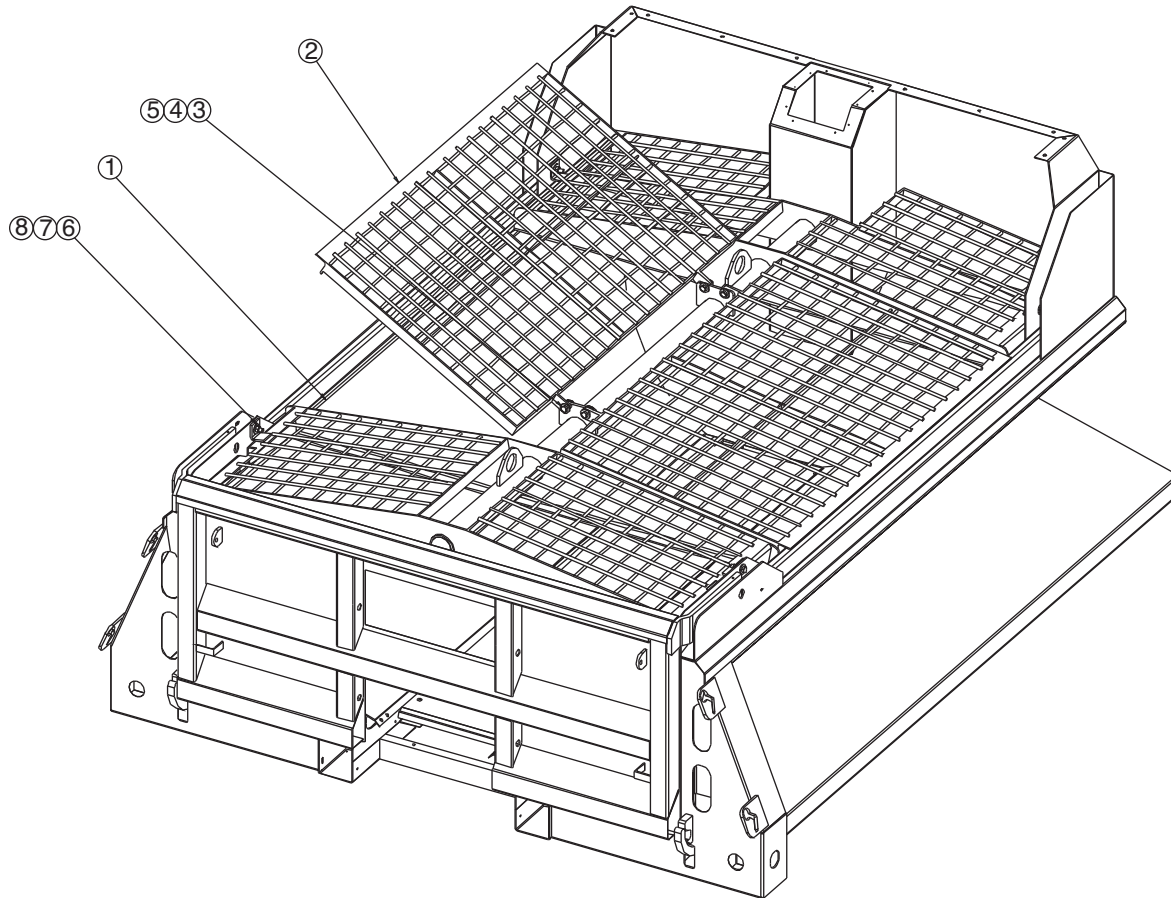

TOP GRATE KIT, 9' PARTS LIST

ITEM	QTY	PART #	DESCRIPTION
1	1	00065468	Top Beam/Frame Weldment, Metro, 9'
2	2	00065455	Top Grate Weldment, Metro, 60
3	4	05010692	Bolt, ½ - 13 x 1¾, G8, HHCS, Zinc
	4	05016204	Bolt, ½ - 13 x 1¾, HHCS, SST
4	4	05020847	Nut, ½ - 13, GC, Top Lock, C&W
	4	05020908	Nut, ½ - 13, Nylon Lock, 316 SST
5	8	05021309	Washer, ½, Flat, Zinc
	8	05021391	Washer, ½, Flat, SST
6	4	05010646	Bolt, ¾ - 16 x 1¾, G8, HHCS, Zinc
	4	05016163	Bolt, ¾ - 16 x 1¾, HHCS, SST
7	4	05020898	Nut, ¾ - 16, Top Lock, C&W, GR C
	4	05020891	Nut, ¾ - 16, Nylon Lock, 316 SST
8	8	05021307	Washer, ¾, Flat, Zinc
	8	05021390	Washer, ¾, Flat, SST

TOP GRATE KIT, METRO, 11'

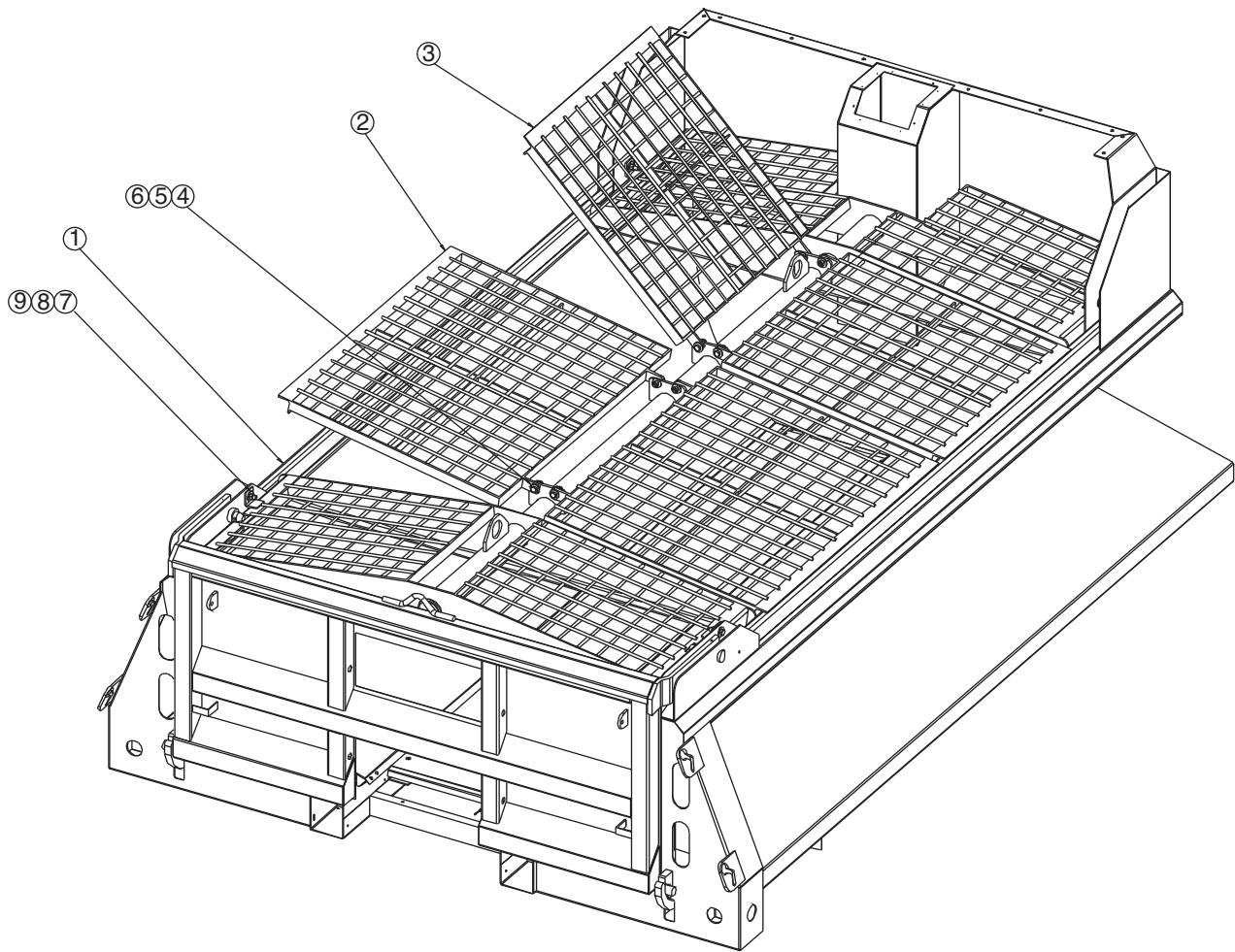

TOP GRATE KIT, 11' PARTS LIST

ITEM	QTY	PART #	DESCRIPTION
1	1	00065468	Top Beam/Frame Weldment, Metro, 11'
2	2	00065455	Top Grate Weldment, Metro, 48
3	2	00066397	Top Grate Weldment, Metro, 36
4	8	05010692	Bolt, ½ - 13 x 1¾, G8, HHCS, Zinc
	8	05016204	Bolt, ½ - 13 x 1¾, HHCS, SST
5	8	05020847	Nut, ½ - 13, GC, Top Lock, C&W
	8	05020908	Nut, ½ - 13, Nylon Lock, 316 SST
6	16	05021309	Washer, ½, Flat, Zinc
	16	05021391	Washer, ½, Flat, SST
7	4	05010646	Bolt, ¾ - 16 x 1¾, G8, HHCS, Zinc
	4	05016163	Bolt, ¾ - 16 x 1¾, HHCS, SST
8	4	05020898	Nut, ¾ - 16, Top Lock, C&W, GR C
	4	05020891	Nut, ¾ - 16, Nylon Lock, 316 SST
9	8	05021307	Washer, ¾, Flat, Zinc
	8	05021390	Washer, ¾, Flat, SST

00065468 TOP BEAM/GRATE FRAME WELDMENT, METRO, 9'
00066391 TOP BEAM/GRATE FRAME WELDMENT, METRO, 11'

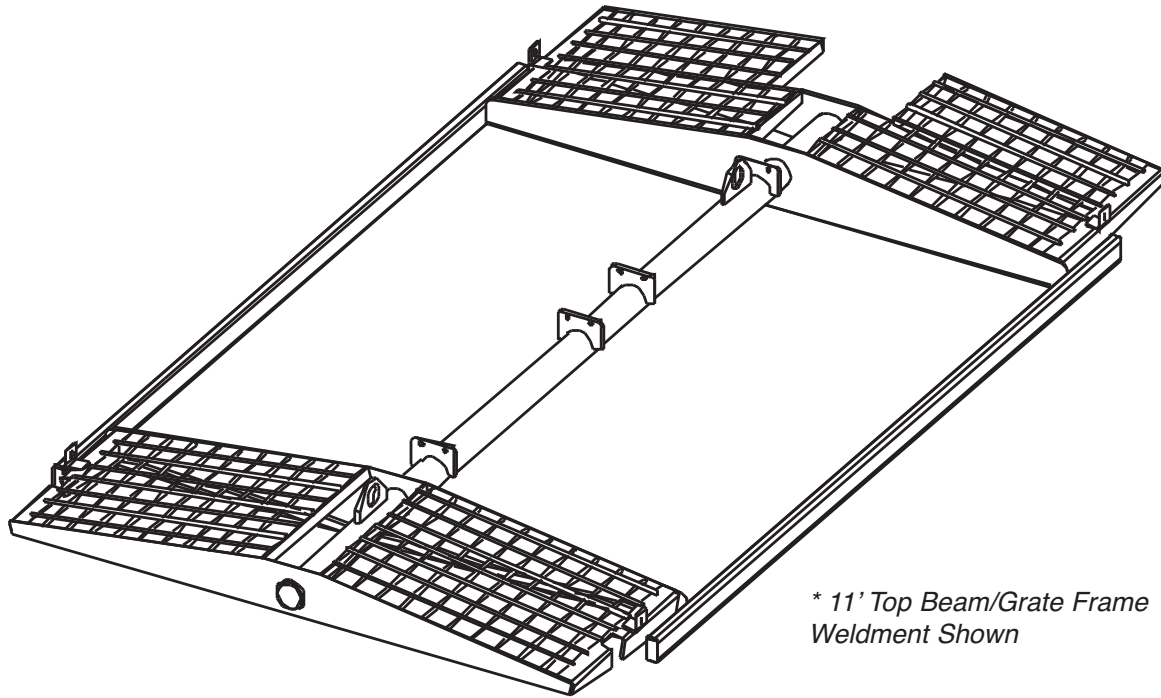

** 11' Top Beam/Grate Frame
Weldment Shown*

INSERT ASSEMBLY, TAILGATE, METRO

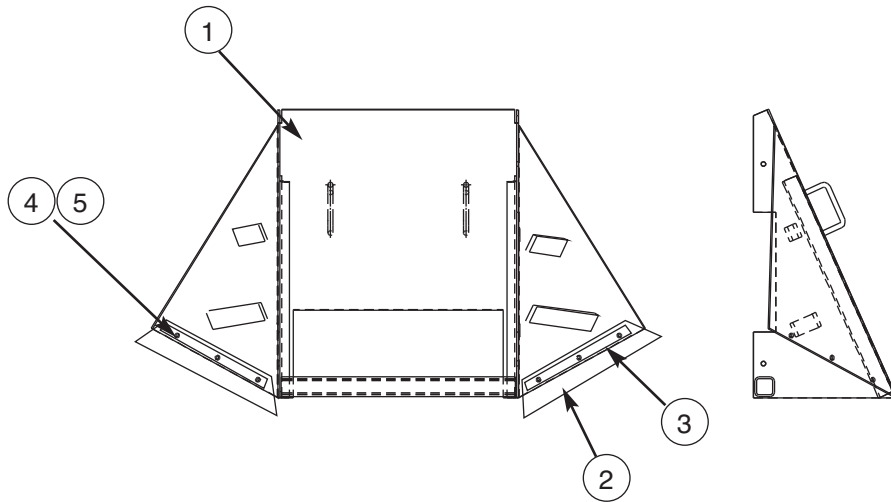

INSERT ASSEMBLY PARTS LIST

ITEM	QTY	PART #	DESCRIPTION
1	1	00048740-A	Insert Weldment, MS
	1	00048741-B	Insert Weldment, 304 SST
2	2	00051871	Wiper, Tailgate Insert
3	2	00038480-A	Support, Rubber Flap, MS
	2	00038480-B	Support, Rubber Flap, 304 SST
4	6	05010644	Bolt, $\frac{3}{8}$ - 16 x 1 $\frac{1}{4}$, G8, HHCS, Zinc
	6	05016049	Bolt, $\frac{3}{8}$ - 16 x 1 $\frac{1}{4}$, HHCS, SST
5	6	05020898	Nut, $\frac{3}{8}$ - 16, GC, Top Lock, Zinc
	6	05020891	Nut, $\frac{3}{8}$ - 16, Nylon Lock, 316 SST

RDS METRO DECALS

PART #	QTY	SIZE	LOCATION
05051404	1	4¼"W X 3⅝"H	Tailgate, Left Side; Upper Panel
05051408	2	6"W X 3"H	Front Stake Pockets; Both Sides
05051409	1	6"W X 3"H	Tailgate; Left Side; Upper Panel
05051402	1	8¼"W X 2¾"H	Rear
05051406	3	8½"W X 3⅝"H	Tailgate; Right Side; Upper Panel; Rear Stake Pockets; Both Sides
05051524	1	3¼"W X 1⅞"H	Longmember, Left Side
05051513	2	5"W X 1½"H	Body Prop Arms
05051525	1	4¼"W X 2⅞"	Longmember, Left Side
05051523	1	5⅞"W X 2⅞"H	Longmember, Left Side
05051514	2	8"W X 5"H	Longmembers, Near Body Prop
05051526	1	2¾"W X 1¾"H	In Cab in a Visible Location
05051407	1	6"W X 3"H	Tailgate, Upper Right Corner
05050738	2	21"W X 2½"H	Body Rails; Left Side; Right Side; Center of Tailgate

05051514

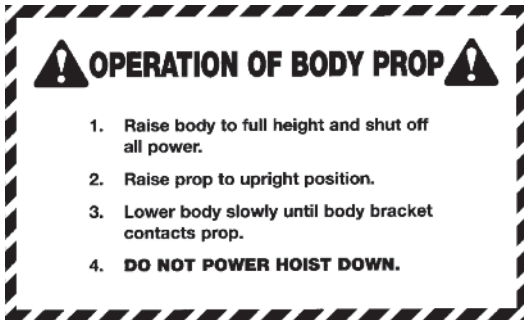

05051404



05051523



05051406

05051525



05051408



05051409

05051402



05051513



05051407

05051526

05051524

05050738

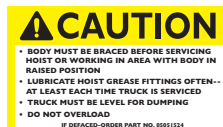
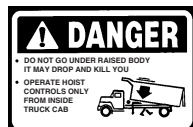

MONROE RDS-METRO

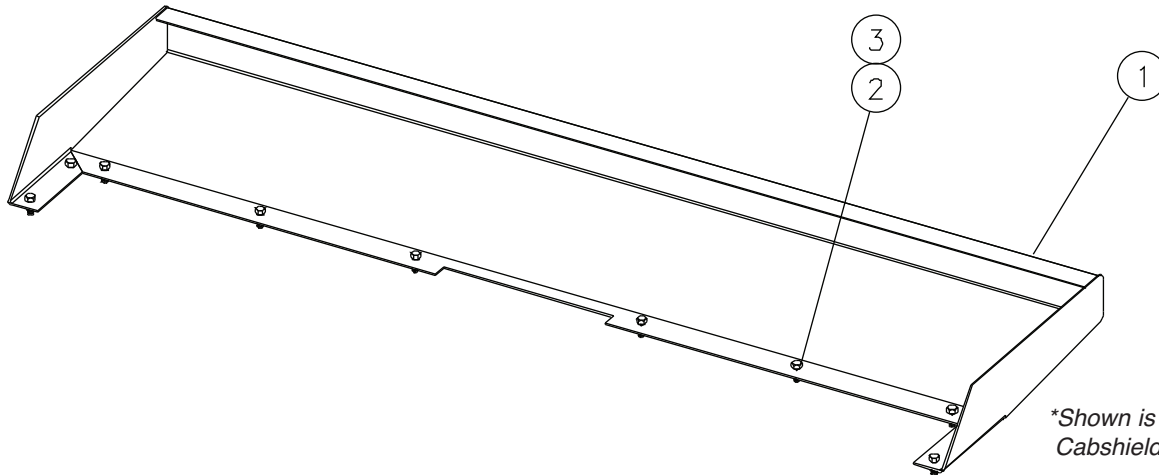

CABSHIELD KIT, BOLT ON, METRO

ITEM	QTY	PART #	DESCRIPTION
1	1	00059827-A	Cabshield Weldment, Metro, 55 x 12, MS
	1	00059827-B	Cabshield Weldment, Metro, 55 x 12, 304 SST
	1	00059827-C	Cabshield Weldment, Metro, 55 x 12, 409 SST
	1	00059831-A	Cabshield Weldment, Metro, 60 x 12, MS
	1	00059831-B	Cabshield Weldment, Metro, 60 x 12, 304 SST
	1	00059831-C	Cabshield Weldment, Metro, 60 x 12, 409 SST
	1	00059869-A	Cabshield Weldment, Metro, 65 x 12, MS
	1	00059869-B	Cabshield Weldment, Metro, 65 x 12, 304 SST
	1	00059869-C	Cabshield Weldment, Metro, 65 x 12, 409 SST
2	10	05010643	Bolt, $\frac{3}{8}$ - 16 x 1, G8, HHCS, Zinc
3	10	05020898	Nut, $\frac{3}{8}$ - 16, Top Lock, C&W, GR C
	10	05020891	Nut, $\frac{3}{8}$ - 16, Nylon Lock, SST

FLOOR COVER KIT, 9' & 11'

ITEM	QTY	PART #	DESCRIPTION
1	1	00065473	Cover, Floor, $\frac{3}{8}$, Poly, 9'
	1	00065474	Cover, Floor, $\frac{3}{8}$, Poly, 11'
2	3	05010644	Bolt, $\frac{3}{8}$ - 16 x 1 $\frac{1}{4}$, G8, HHCS, Zinc
	3	05016049	Bolt, $\frac{3}{8}$ - 16 x 1 $\frac{1}{4}$, HHCS, SST
3	3	05020898	Nut, $\frac{3}{8}$ - 16, Top Lock, C&W, GR C
	3	05020891	Nut, $\frac{3}{8}$ - 16, Nylon Lock, 316 SST
4	6	05021307	Washer, $\frac{3}{8}$, Flat, Zinc
	6	05021390	Washer, $\frac{3}{8}$, Flat, SST

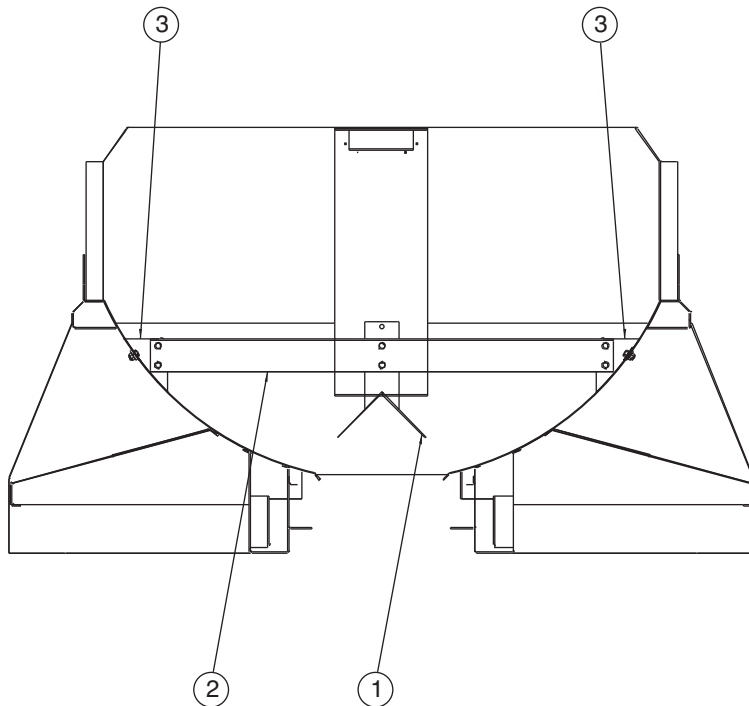
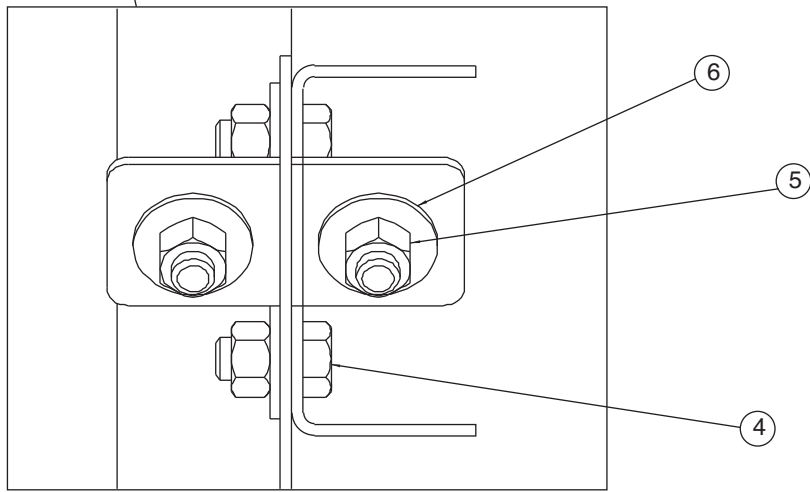
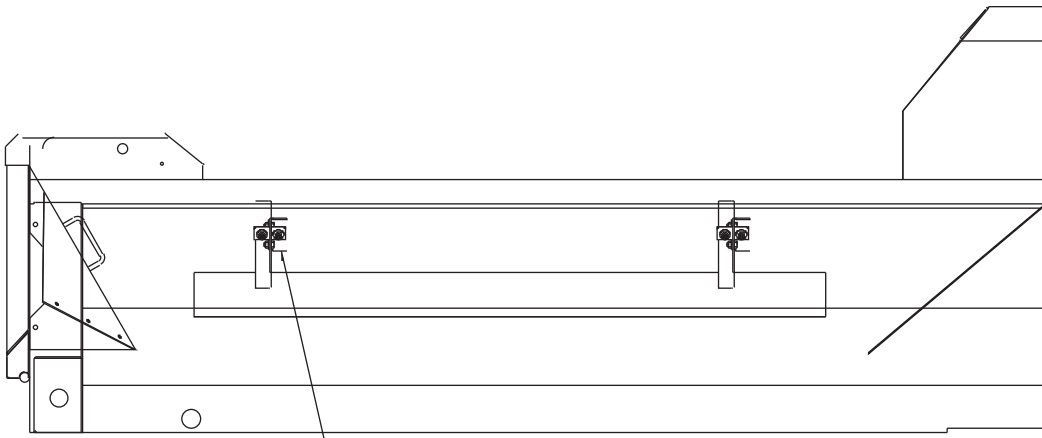

00012911 INVERTED V KIT, 9'			
Item	Qty	Part Number	Description
1	1	00065440-A 00065440-B	Inverted V Weldment, 9', MS Inverted V Weldment, 9', SST
2	2	00053221-A 00053221-B	Cross Channel, MS Cross Channel, SST
3	4	00053441-A 00053441-B	Bracket Weldment, MS Bracket Weldment, SST
4	20	05010689 05016047	Bolt, ½-13 x 1, G8, HHCs, Zinc Bolt, ½-13 x 1, HHCs, SST
5	20	05020847 05020908	Nut, ½-13, GC, Top Lock, C&W Nut, ½-13, Nylon Lock, SST
6	20	05021309 05021391	Washer, ½, Flat, Zinc Washer, ½, Flat, SST

00065442 INVERTED V KIT, 11'			
Item	Qty	Part Number	Description
1	1	00065441-A 00065441-B	Inverted V Weldment, 11', MS Inverted V Weldment, 11', SST
2	2	00053221-A 00053221-B	Cross Channel, MS Cross Channel, SST
3	4	00053441-A 00053441-B	Bracket Weldment, MS Bracket Weldment, SST
4	20	05010689 05016047	Bolt, ½-13 x 1, G8, HHCS, Zinc Bolt, ½-13 x 1, HHCs, SST
5	20	05020847 05020908	Nut, ½-13, GC, Top Lock, C&W Nut, ½-13, Nylon Lock, SST
6	20	05021309 05021391	Washer, ½, Flat, Zinc Washer, ½, Flat, SST

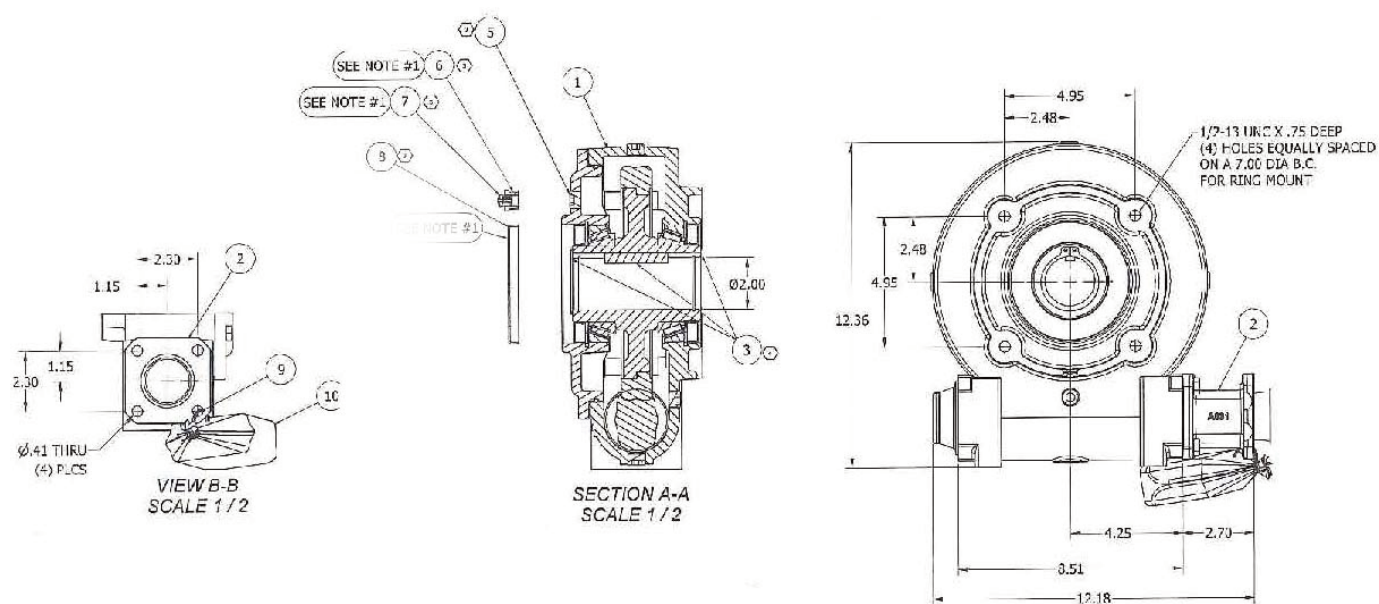

05007427 GEARBOX, 25:1

Item	Qty	Part Number	Description
1	1		Worm Drive Assembly <i>(See next page)</i>
2	1	05007452	4-Bolt Hyd Adapter Kit
3	1	05007459	2" Dia. Shaft Output Kit
5	1	05007122	Hex Plug
6	1	05007460	Reducer
7	1	05007461	Pressure Relief
8	1	05007458	Expansion Plug

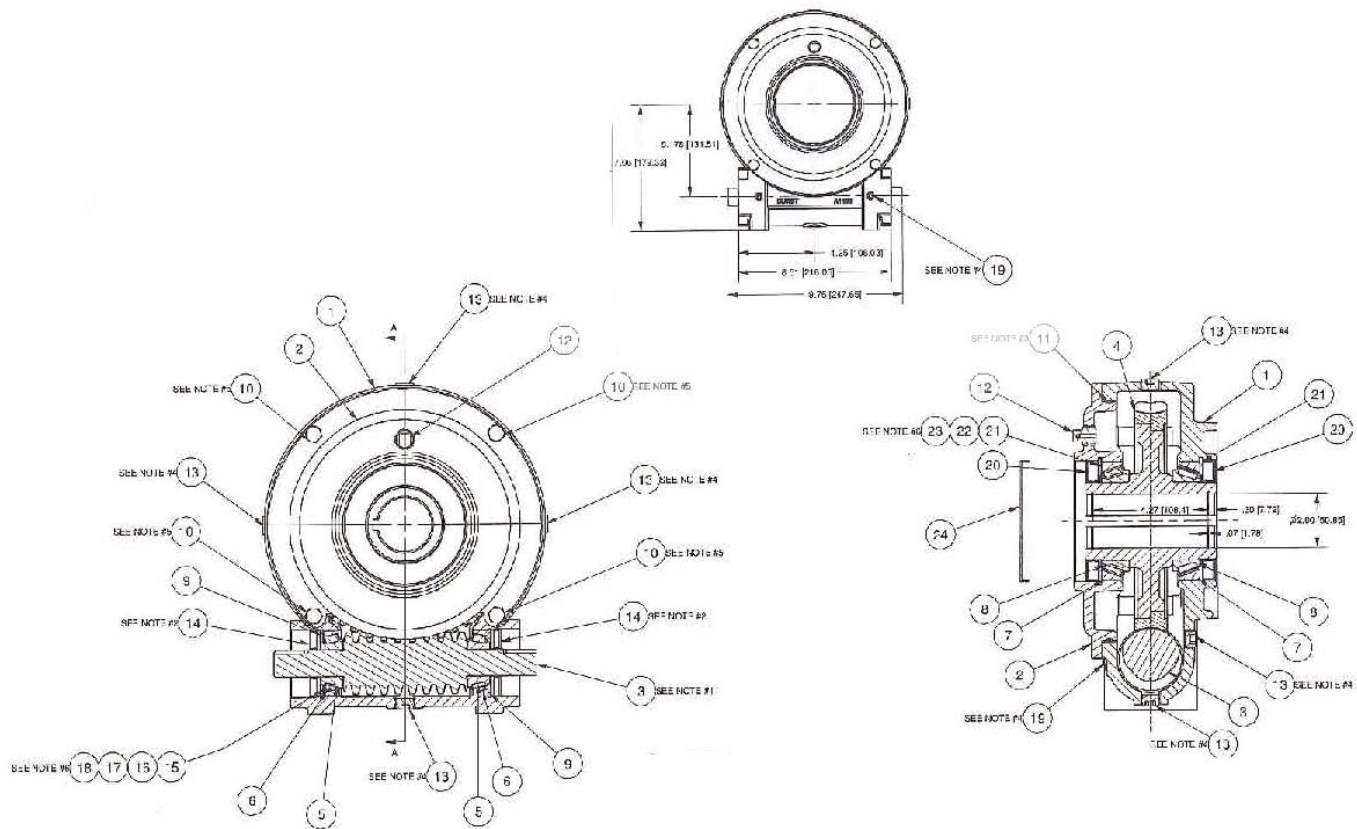

WORM DRIVE ASSEMBLY FOR 05007438 GEARBOX

Item	Qty	Part Number	Description
5	2	05007055	Cone, Bearing, Input
6	2	05007305	Cup, Bearing, Input
7	2	05007464	Cup, Bearing, Output
8	2	05007465	Cone, Bearing, Output
9	2	05007059	Retaining Ring
10	4	05010643	Bolt, .375-16 UNC x 1 Long
11	1	05007457	O-Ring, #269, 8.734 x 9.12 x .139, Vitron (For Cover)
12		---	Pipe Vent, Square Head
13	2	05007122	Plug, Hex Socket Pipe
14	2	05007456	Input Seal, 1 x 2.533 x .25
15		05007072	Shim, 2 x 2.406 x .2
16		05007466	Shim, 2 x 2.406 x .007
17		05007467	Shim, 2 x 2.406 x .005
18		05007468	Shim, 2 x 2.406 x .010
19	1	05007469	Socket Head Pipe Plug
20	2	05007455	Output Seal, 2.875 x 4.501 x .439
21	2	05007470	Internal Retaining Ring
22		05007471	Shim, 3.94 x 4.41 x .005
23		05007472	Shim, 3.94 x 4.41 x .010
24	1	05007458	Cap, Plug, Expansion, 4.5" Bore

05006060 MOTOR, 6.3 C.I.D., 1" SHAFT

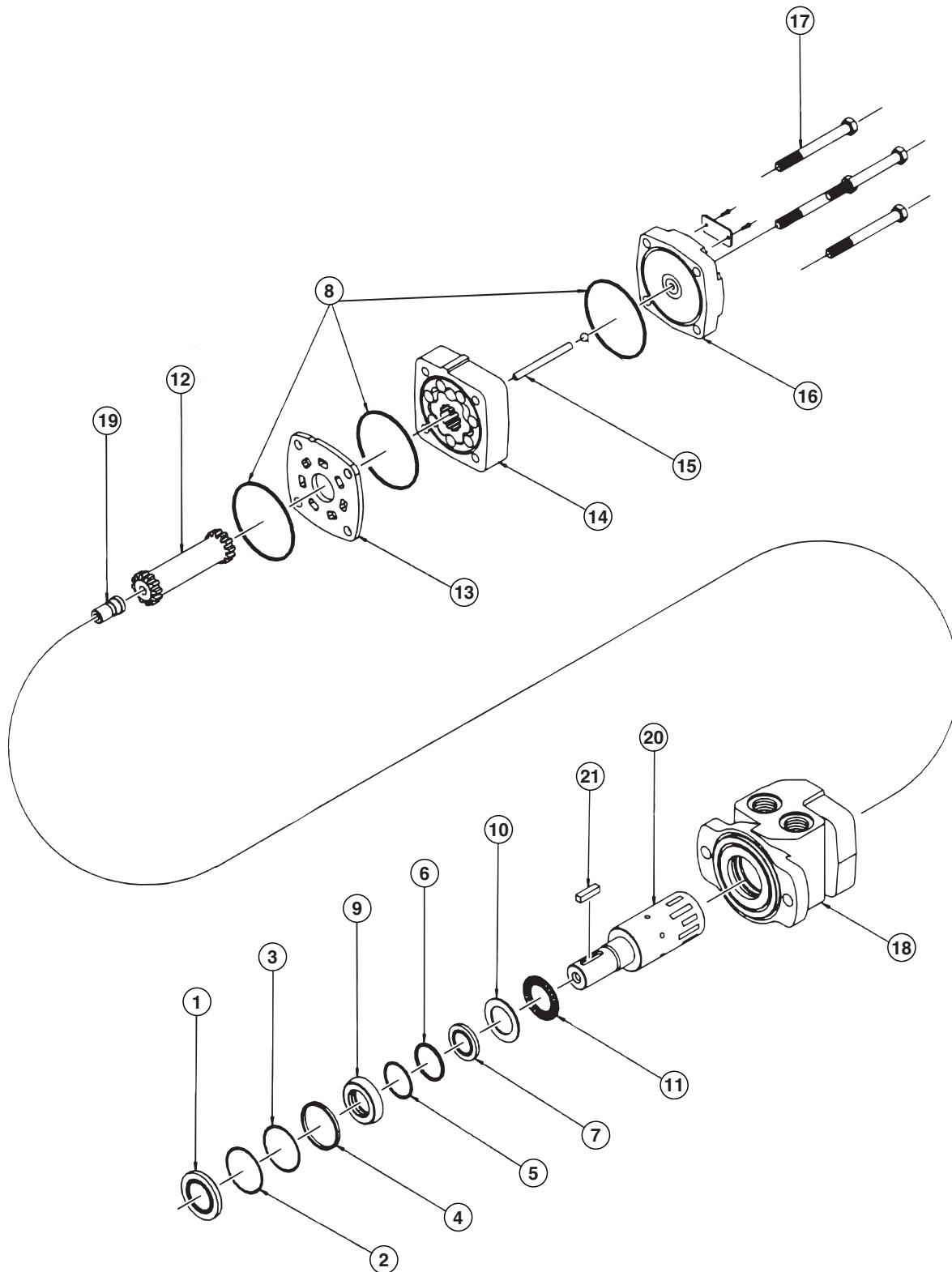

05006060 MOTOR PARTS LIST

ITEM	QTY	PART #	DESCRIPTION
	1	05006061	Seal Kit <i>(Items 1-10 are included in the Seal Kit and can not be purchased separately.)</i>
1	1		Seal, Dust
2	1	--	Ring, Split Wire
3	1	--	Shim, Metal Backup
4	1	--	Seal, High Pressure
5	1	--	Shim, Metal Backup
6	1	--	Shim, Teflon Backup
7	1	--	Seal, Shaft
8	3		Seal, Body
9	1	--	Seal, Carrier
10	1	--	Washer, Thrust
11	1	05006357	Bearing, Thrust
12	1	05006062	Drive Link Kit
13	1	05006359	Wear Plate
14	1	05006059	Rotor Kit
15	1	05006063	Drive Link Pin Kit
16	1	05006360	End Cover
17	1	05006064	Bolt Set Kit
18	1	05006369	4-Hole w/ ½" NPT, Housing Kit
19	1	05006358	Cooling Plug
20	1	05006370	Shaft Kit, 1" Straight
21	1	05006371	Key Kit, 1" Straight

05006134 Motor, 3.2 C.I., 4-Bolt, ½" NPT

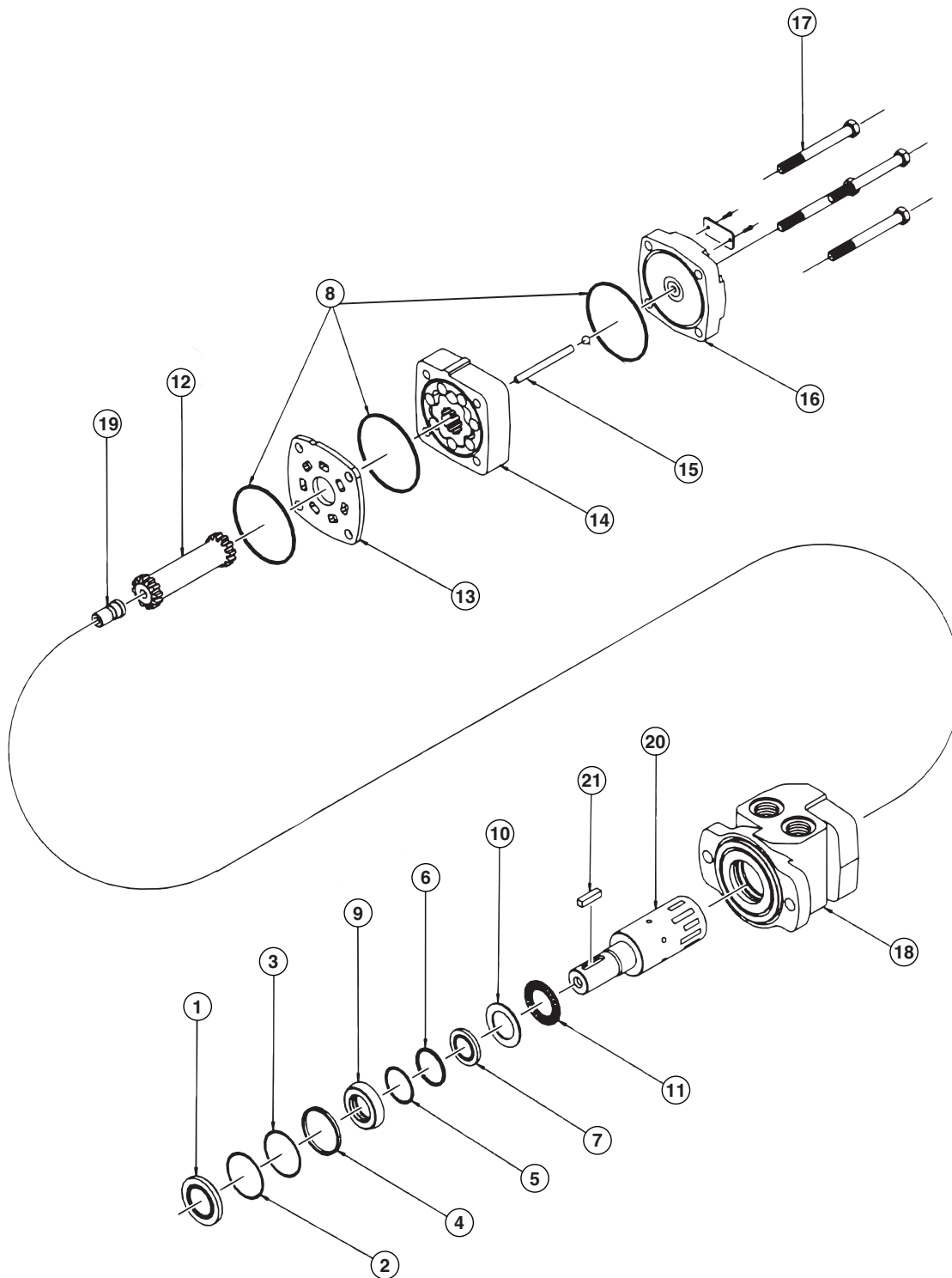

05006134 MOTOR PARTS LIST

ITEM	QTY	PART #	DESCRIPTION
	1	05006061	Seal Kit <i>(Items 1-10 are included in the Seal Kit and can not be purchased separately.)</i>
1	1	--	Seal, Dust
2	1	--	Ring, Split Wire
3	1	--	Shim, Metal Backup
4	1	--	Seal, High Pressure
5	1	--	Shim, Metal Backup
6	1	--	Shim, Teflon Backup
7	1	--	Seal, Shaft
8	3	--	Seal, Body
9	1	--	Seal, Carrier
10	1	--	Washer, Thrust
11	1	05006357	Bearing, Thrust
12	1	05006362	Drive Link Kit
13	1	05006359	Wear Plate
14	1	05006361	Rotor Kit
15	1	05006363	Drive Link Pin Kit
16	1	05006360	End Cover
17	1	05006364	Bolt Set Kit
18	1	05006369	4-Hole w/ 1/2" NPT, Housing Kit
19	1	05006358	Cooling Plug
20	1	05006370	Shaft Kit, 1" Straight
21	1	05006371	Key Kit, 1" Straight

HOW TO ORDER PARTS

To order or inquire about replacement parts, please contact the **distributor** or **store** that the product was purchased through. To speed the information flow, please have the following information ready:

- Model Number
- Serial Number
- Part Number and/or description as per the parts manual
- Quantity needed

For further information about **Monroe Truck Equipment** replacement parts, please call 800-880-0109 and ask for **Snow & Ice Parts Sales**.

RETURN POLICY

Merchandise returned to **Monroe Truck Equipment** must have a Returned Goods Authorization (RGA) form filled out completely and signed by authorized personnel. To get your RGA form, call 800-880-0109. For whole goods, ask for **Snow & Ice Sales**. For replacement parts, ask for **Snow & Ice Parts Sales**. All returned items are subject to a 15% restocking fee and must be sent freight prepaid!

ORDERING CUSTOM MADE CHAINS

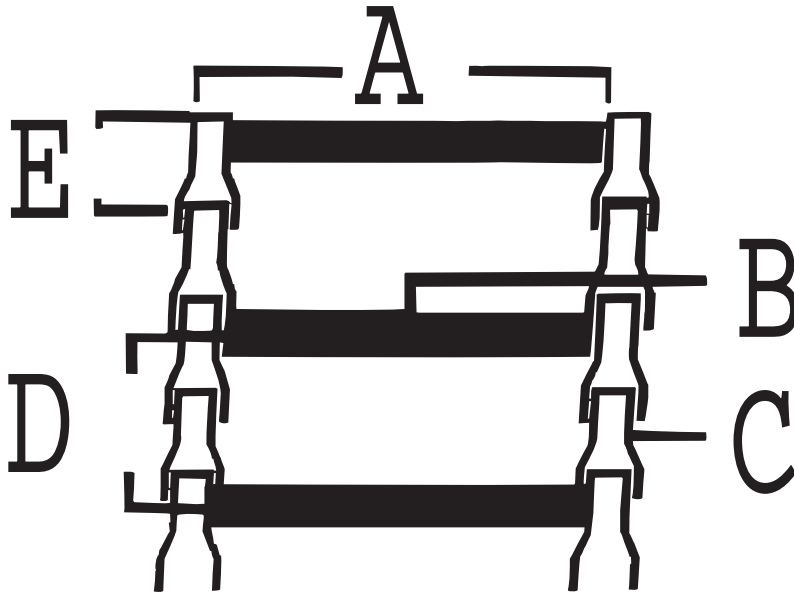

A = Center to Center - this may be measured from the sprockets or from a piece of chain making sure to measure from equivalent points.

B = Bar Type, i.e., 1/4 x 1 1/2, 3/8 x 1 1/2, 1/4 x 1 or 1/4 x 3/4

C = Chain No., i.e. D662, D667X, D88K may be stamped in metal

D = Bar Spacing, i.e., every other link, every 3rd, every 4th

E = Pitch Size - This is measured from the center of one pin to the center of the next pin, i.e., D662 is 1.664"; D667X is 2.25"; D88K is 2.609"

Chain No.	Sprocket Ct. to Ct.	Bar Spacing	Bar Type	Pitch Size	Length # of Links	Qty

*** Chain w/bar every link is not recommended for use with gravel/stone chips.*

MONROE WARRANTY
SPREADER-SCRAPERS-SNOWPLOW-S-HITCHES-WINGS

Monroe Truck Equipment, Inc. warrants to the original purchaser, that if any part of the product proves to be defective in workmanship or material within ONE YEAR of the original installation, and is returned to us within 30 days of the discovered defect, we will (at our option) repair or replace the defective part. This warranty does not apply to damage resulting from misuse, neglect, accident, improper installation, normal wear items or lack of maintenance. This warranty is exclusive and supercedes all other warranties, whether expressed or implied. **Monroe Truck Equipment** neither assumes, nor authorizes anyone to assume for it, any other obligation or liability in connection with this warranty and will not be liable for consequential damages.

All engines, pumps, motors, cylinders and valves are warranted by their manufacturer and not by **Monroe Truck Equipment**. The manufacturer's warranty will apply to these parts. Electrical and hydraulic components are not to be disassembled without the express written permission of **Monroe Truck Equipment**. Use of replacement parts other than original equipment voids this warranty.

All defective parts returned must be accompanied by the model number, serial number, date installed, date of defect, description of defect, and the name of the distributor from whom it was purchased. All warranty claims must have prior written approval from **Monroe Truck Equipment**.

WARRANTY REGISTRATION

MODEL # _____ DATE OF PURCHASE _____

SERIAL # _____ FROM _____

NAME: _____

ADDRESS: _____

CITY/STATE: _____ ZIP: _____

IMPORTANT!

Return of this warranty registration information confirms receipt of this parts catalog and acknowledges the information contained within. Please fill in the blanks, photocopy, and either fax or mail entire page to:

*Monroe Truck Equipment
1051 W. 7th Street
Monroe, WI 53566
Fax: 608-329-8369*

AUTHORIZED SIGNATURE _____